



ODYSSEYS ABOARD

LE COMMANDANT CHARCOT

2025 • 2026 SEASONS



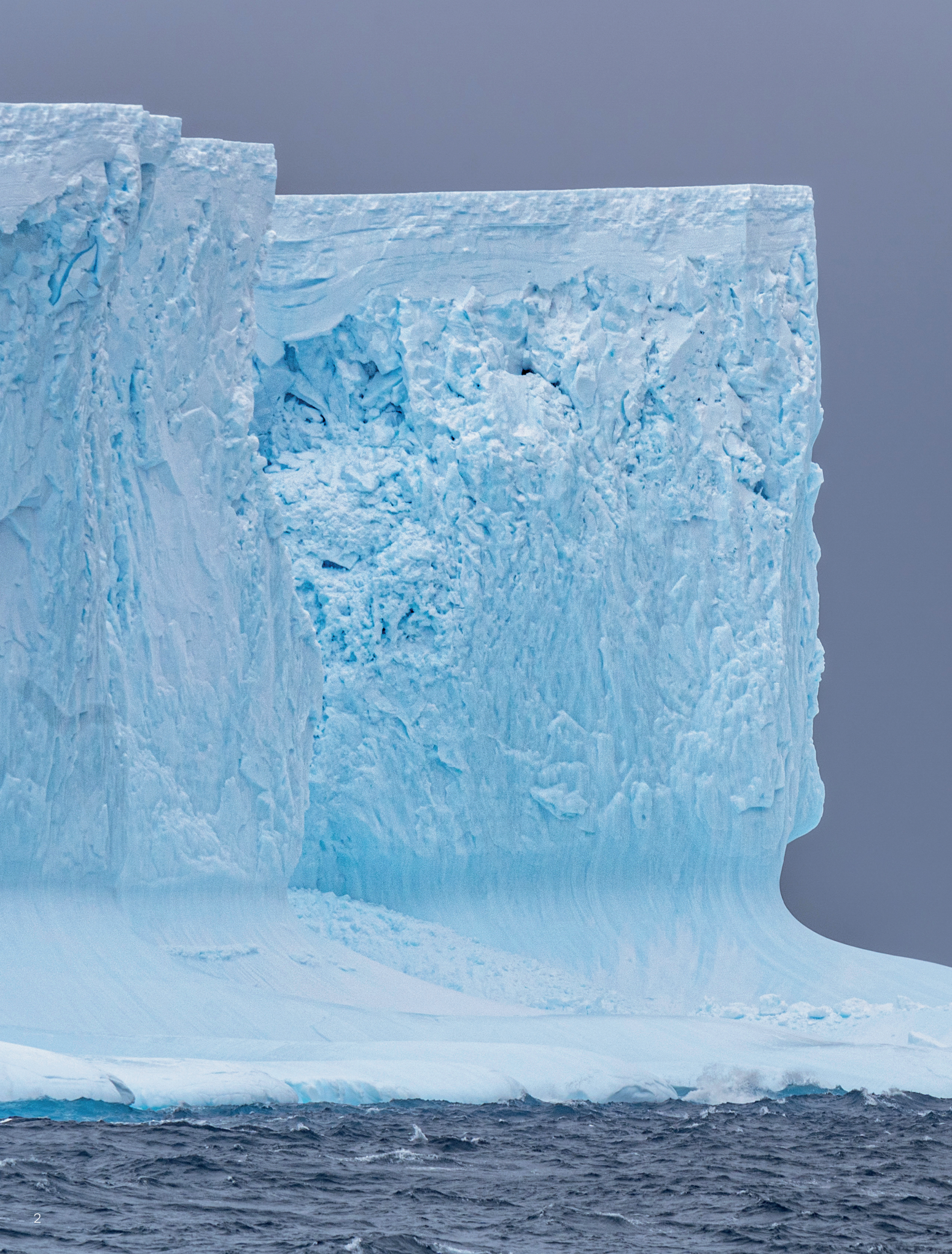

Breaking Boundaries in True Luxury

Close your eyes and you can almost hear it... the crunch of snowshoes on ice that has been around for many millennia, the creaking and calving of glaciers as they retreat and advance into the sea. The roar of a polar bear trekking ice floes in the Arctic; the song of the emperor penguin calling his mate far south of the legendary Antarctic Circle. The transformative power of the sound of silence.

Once the domain of intrepid explorers, accessing the edges of the Earth is an eye-opening experience, especially when exploring aboard the world's only luxury icebreaker, *Le Commandant Charcot*. This strikingly elegant ship is capable of navigating the most extreme polar environments - from the Arctic's elusive Magnetic and Geographic North Poles to the rarely-traversed reaches of Antarctica's Weddell Sea - quietly maneuvering among cathedral-like icebergs and monumental ice shelves with a design that keeps your connection to nature omnipresent.

Le Commandant Charcot takes you deeper into the ice to places where others simply cannot go, presenting you with once-in-a-lifetime opportunities: drifting through the ice floes of Greenland's unexplored Blosseville Coast for an overnight Nordic skiing polar trek; dog-sledding on frozen tundra, an Inuit tradition; veering far into the Southern Ocean for the daredevil act of polar plunging; and gliding into the St. Lawrence River during the Boreal winter for a first-of-its-kind navigation through fragmented and solid ice.

Captained by seasoned navigators and staffed with an experienced crew, every expedition invites a curated roster of esteemed scientists, expert photographers, and prestigious members of **The Explorers Club*** aboard to enhance your discoveries with hands-on research and conversation with real-world adventurers.

Shackleton, Amundsen, and Charcot may have been among the first to explore the poles, but they charted the course so you could be next.

**PONANT, in partnership with The Explorers Club—an esteemed international organization dedicated to advancing field exploration and scientific inquiry—has crafted exclusive voyages for our discerning guests. These exceptional journeys unite science and curiosity, offering an unparalleled experience.*

CONTENTS

1



A UNIQUE SHIP

P. 14

Combining responsible design and technological prowess, *Le Commandant Charcot* carries you safely and comfortably beyond known lands.

LIFE ON BOARD

P. 30

Sleek design, fine dining, new spaces, new partners, and tailor-made services extend and enhance the polar experience.

A TEAM OF EXPERTS

P. 42

Captains, expedition leaders, naturalist guides, photo ambassadors, and renowned guests will bring their polar expertise on your voyage.

2

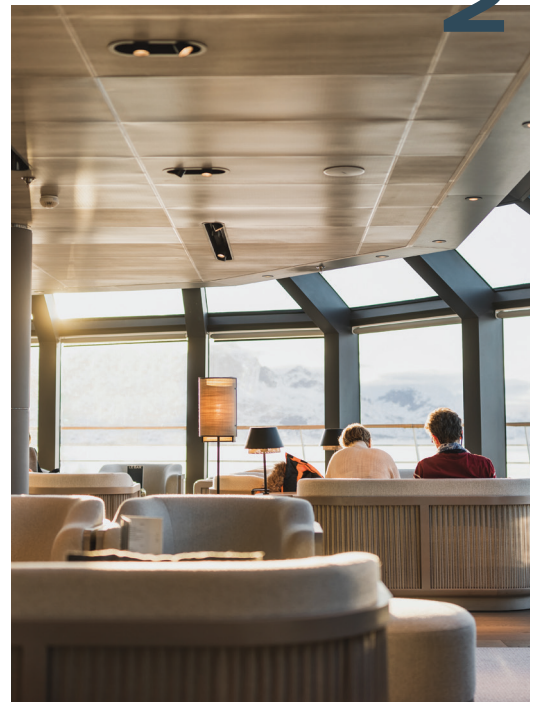

3



ANTARCTICA, AN ULTIMATE JOURNEY

P. 52 to 61

Follow in the footsteps of the great polar explorers on routes through some of the most isolated regions of the world that are little known and scarcely mapped.

EXPERIENCE THE ARCTIC

P. 62 to 89

Set sail on an epic journey to the planet's northernmost latitudes, discover fascinating wildlife, and visit the traditional villages of the Greenlandic Inuit.



4



5



6



7

WINTER IN THE GREAT NORTH

P. 90 to 101

Experience the magic of the Far North on a unique journey through the heart of the boreal winter, with itineraries that are absolute firsts.

WELCOME ON BOARD

P. 104 to 111

View deck plans, staterooms, and suites.

ANTARCTICA, AN ULTIMATE JOURNEY

<i>date</i>	<i>itinerary</i>	<i>nights</i>	<i>page</i>
October 30, 2025*	Ushuaia · Ushuaia	12	54
December 5, 2025*	Ushuaia · Ushuaia	14	56
January 16, 2026	Ushuaia · Hobart	29	58
February 17, 2026	Hobart · Cape Town	28	60

A SUMMER IN THE ARCTIC

<i>date</i>	<i>itinerary</i>	<i>nights</i>		<i>page</i>
March 21, 2025*	Reykjavík · Nuuk	15	with The Explorers Club	64
April 5, 2025	Nuuk · Nuuk	12		66
May 4, 2025*	Reykjavík · Reykjavík	10		70
May 24, 2025*	Reykjavík · Reykjavík	14		78
June 21, 2025*	Reykjavík · Longyearbyen	16	with The Explorers Club	82
July 22, 2025*	Longyearbyen · Longyearbyen	15		84
September 5, 2025	Longyearbyen · Nome	20	Exclusive with The Explorers Club	88

**Additional dates available for this itinerary. See page for full details.*



DEPARTURES CALENDAR

WINTER IN THE GREAT NORTH

<i>date</i>	<i>itinerary</i>	<i>nights</i>		<i>page</i>
January 17, 2025*	Saint Pierre and Miquelon • Québec	12	Exclusive	94
January 29, 2025*	Québec • Saint Pierre and Miquelon	12	Exclusive	94
March 6, 2025	Saint Pierre and Miquelon • Reykjavík	15	Exclusive with The Explorers Club	98



EXPLORE TO INSPIRE

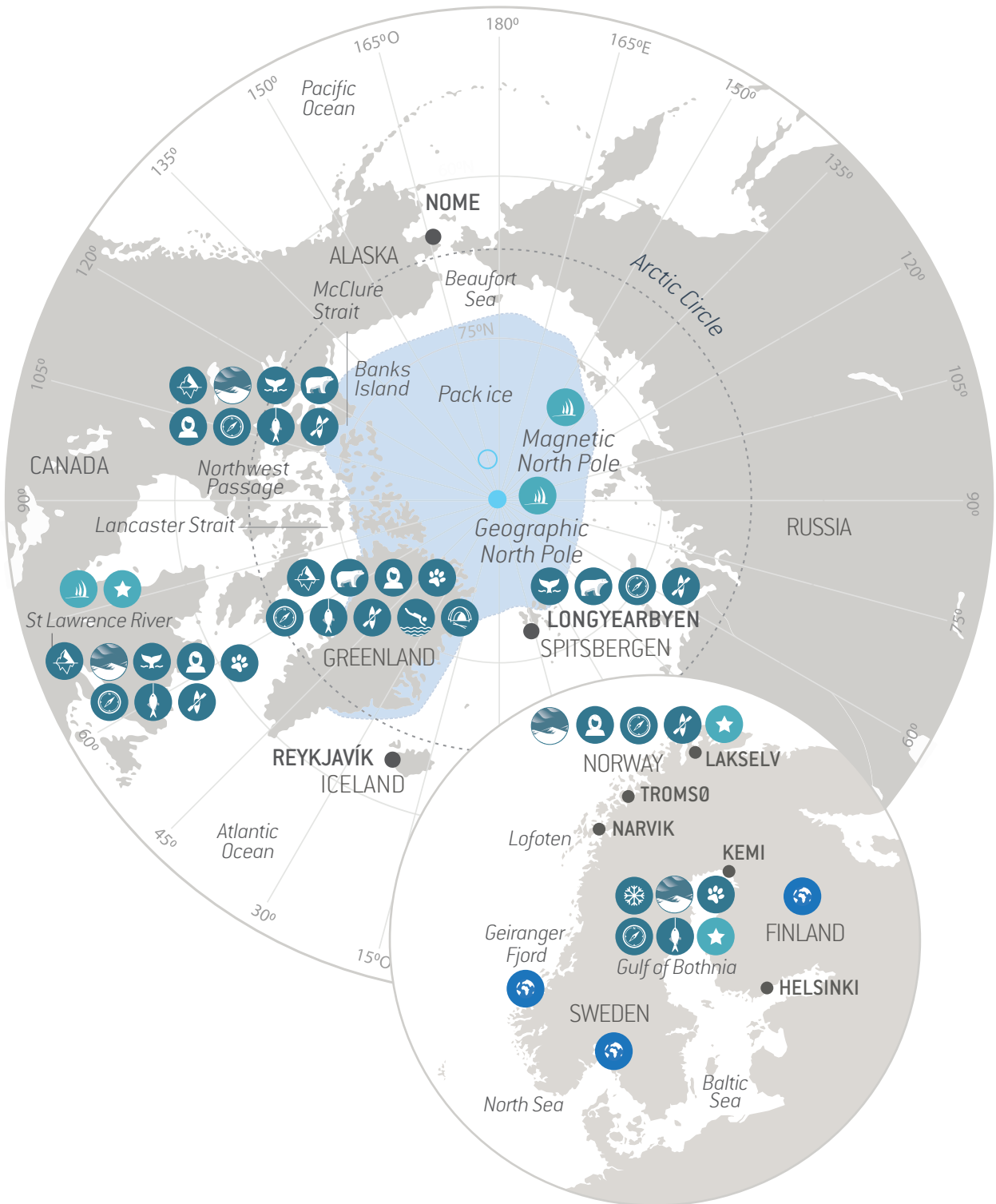

The activities and the observation of wildlife are subject to weather and ice conditions as well as sailing opportunities and cannot be guaranteed. For a detailed list of voyage highlights, see the pages dedicated to each itinerary.

Join *Le Commandant Charcot* in the polar extremes in 2025 and 2026



HIGHLIGHTS

 Sailing among the ice floes

 Iconic wildlife

 Indigenous people

 Sea kayak

 Polar trek

 Snow

 Polar bears

 Dogsledding

 Polar plunge

 UNESCO sites

 Northern Lights

 Emperor penguins

 Ice fishing

 Hiking

 PONANT exclusive

 New ports of call

10

EXCLUSIVE EXPERIENCES

on board
Le Commandant Charcot



1 REACHING THE UNREACHABLE

Embark on an odyssey beyond the Antarctic Peninsula and stake your claim as one of **the only visitors to the region in early November**. You'll observe wildlife including blue, fin, humpback, and minke whales as they migrate south and navigate the ice floes, along with Adélie, chinstrap, gentoo, and maybe even emperor penguins. Or head north and visit the Inuit villages of Greenland **as early as April, several weeks before any other ship**. Stay in the Arctic in winter and enjoy the magic of the Northern Lights, or cross a frozen St. Lawrence River at the beginning of the year. A truly powerful ship, *Le Commandant Charcot* can take you on immersive itineraries through the world's most remote regions, some of which have never been visited or even mapped. Jean-Baptiste Charcot, Roald Amundsen, and Ernest Shackleton were among the first explorers to venture into the polar worlds; now, it's your turn.

2 THE WORLD'S FIRST AND ONLY EXTREME POLAR EXPLORATION VESSEL

To start, a bit of background: Polar Class (PC) refers to a ship's ability to navigate and break through ice throughout the year. On a scale of 1 - 7, PC1 ships offer year-round operations in all polar waters; PC7 ships are able to cruise through first-year ice in the summer and autumnal months only. With that out of the way, we present to you **the only passenger ship in the world with a PC2 classified hull**, which allows for navigation through multiyear ice, *Le Commandant Charcot*. An icebreaker, she is built to transport you to the most magical destinations where time seems to stand still, and the vast deserts of ice offer dazzling colors and otherworldly landforms that shift and change before your eyes. Contrary to popular belief, the ice fields are far from featureless. "We're entering another world, hitherto unexplored," explained Étienne Garcia, one of the ship's captains. On board these special sailings, the landscape reveals **remarkable discoveries for the guests**.

3 LEADING EXPERTS BY YOUR SIDE

For the past 35 years, PONANT has been creating trips to isolated destinations, guided by nature and a desire to promote cultural enrichment. On board *Le Commandant Charcot*, this translates into a team of **approximately 20 nature guides**, offering guests an unmatched ratio on our expeditions. This also means officers on board are given extensive training to skilfully navigate the ice.

4 A TRUE, ONCE-IN-A-LIFETIME IMMERSION INTO THE POLAR EXPERIENCE

To really connect with the natural world, join an optional excursion on our expeditions to Greenland, and spend **two days and one night off the ship, camping in the heart of the ice**, in the company of Inuit guides. Other activities include the chance to board **kayaks from a patch of pack ice**; get your heart racing on a dog-sled ride through a breathtaking landscape; and **visit traditional villages in the middle of winter**, or the very start of spring. These experiences open the doors to an authentic and spectacular setting, well beyond the limits of your imagination.



5

INSIDE/OUTSIDE: THE INVISIBLE FRONTIER

The perfect vantage points to admire the **stunning scenery**, the ship's communal areas were designed by world-renowned architects Jean-Philippe Nuel and Jean-Michel Wilmotte, and offer a cozy cocoon in even the most extreme environments. Created to let the outside in, *Le Commandant Charcot* features **unique spaces** that set her apart from the rest of our fleet, such as the Blue Lagoon, an open-air lagoon heated using recovered energy; indoor swimming pool; snow cabin; detox bar within the spa; and Cigar Lounge.

THE ONLY ALAIN DUCASSE RESTAURANT AT SEA

The one and only Alain Ducasse gourmet restaurant at sea, *Nuna* ("Earth" in Greenlandic) features a menu dreamed up by the Michelin-starred chef himself, as well as some of his signature dishes. Delicate flavors are combined with refined tableware to achieve an unparalleled level of excellence in such isolated surroundings. Whenever possible, the onboard chef also offers memorable **PONANT moments** by cooking up the catch of the day from the local villages.

6

SAILING FOR SCIENCE

The only French vessel capable of venturing deep into the ice, *Le Commandant Charcot* is part of the PONANT Science project. It provides the international scientific community with **two laboratories** equipped with state-of-the-art facilities, which are involved in research in many fields related to the ocean, the environment, and climate change. The results are shared as open data, and are available to the public.



A MORE ENVIRONMENTALLY FRIENDLY HYBRID ENGINE

Le Commandant Charcot utilizes the most advanced technologies in order to **reduce her impact on the places she visits**. The hybrid electric/liquefied natural gas engine enables her to considerably reduce emissions: -25% CO₂ emissions, -85% nitrogen oxides, and -95% fine particles. Cleanship certified by Bureau Veritas - like the rest of the PONANT fleet - *Le Commandant Charcot* has also embraced energy recycling; controlled consumption; waste reduction, sorting, and monitoring; and the elimination of single-use plastics. To find out more, see our sustainable development report via QR code, below.

TRUE MASTERS AT THE HELM

Étienne Garcia, Patrick Marchesseau, and Stanislas Devorsine are the **intrepid captains behind the wheel** of *Le Commandant Charcot*. They are experienced, personable, and passionate adventurers who are only too eager to conquer the elements while navigating this, the world's first luxury icebreaker. They truly are three masters at the helm.

THE PONANT ADVANTAGE

Solo travelers, family and friends, adventurers embarking on back-to-back voyages, or those traveling as part of our PONANT Yacht Club loyalty program: **we offer benefits for every guest**. Find all our offers on our website: <https://en.ponant.com/ponant-benefits>



Read our sustainable development report



A UNIQUE





SHIP

Primus inter pares – first among equals

Designed to sail the most inaccessible regions of the planet, *Le Commandant Charcot* has already demonstrated its ability to go further, where others don't—or can't—go.

78°44.3'S

The first ship in the world to reach the **southernmost navigable latitude** in the Ross Sea, in February 2022.

"We were enclosed by fog when we discovered the furthest point south ever reached by a ship. I didn't know that a fortnight earlier, an American icebreaker had arrived slightly further north, claiming the record. I met its captain a few months later, and he took the news really well!"

Captain Patrick Marchesseau

74°50'S, 102°40'W

In February 2023, *Le Commandant Charcot* became the first passenger ship to venture to **Pine Island Bay**, at the southeastern tip of the Amundsen Sea, on the first-ever half-circumnavigation of Antarctica. One of the longest expedition voyages ever made, in terms of both distance and time, for which PONANT also holds the record (over 14,400 km covered).

"It's one of the most beautiful ocean voyages I've ever made. We've been to regions that we've actually discovered, and where, with the exception of a few scientists some 20 years ago, nobody has ever been. Every day, we had the impression that we had reached the pinnacle of what Antarctica had to offer and yet, the next day, it was a new wonder."

Captain Stanislas Devorsine

74°42'N, 117°00'O

The first cruise ship to pass through the **McClure Strait**, at the mouth of the Beaufort Sea in the Canadian Northwest Territories, in September 2022. This historic voyage gave our guests the chance to observe several polar bears.

*"The McClure Strait is regularly impassable, with thick ice, and the weather is difficult to predict in this region. *Le Commandant Charcot* is designed for this kind of challenge, which is a real highlight for me as a sailor."*

Captain Étienne Garcia

90° NORTH PARALLEL

The first French vessel to reach the **Geographic North Pole** in September 2021. She took her first guests there in July 2022.



AWARDS

Our awards

- 'Best Cruise Ships in the World'
Condé Nast Traveler magazine in its Gold List 2023
- 'Best of the Arctic,' Cruise Critic Editors' Choice 2023
- TIME's: 'World's Greatest Places'
The Arctic on board *Le Commandant Charcot* among the 50 most beautiful places in the world
- 'Best Antarctic Cruise'
Porthole Cruise and Travel Magazine, 2023 Reader's choice Awards
- '10 Favorite Intimate-ship Ocean Cruise Lines of 2023'
Travel + Leisure's Worlds' Best Awards
- 'Cruise ship of the year' awarded to *Le Commandant Charcot* at the 15th edition of the Seatrade Cruise Awards 2021.

Our labels and certifications

- 100% of the fleet labeled Cleanship by Bureau Veritas.
- One of the most environmentally friendly cruise companies, according to the German NGO Nabu.
- Signatory to the Global Tourism Plastics Initiative, a United Nations program to ban the use of single-use plastics.

“Our destination: a more sustainable future”

This trajectory, announced by Hervé Gastinel, CEO of PONANT, reflects the company's objective to decarbonize towards net zero by 2050.

Le Commandant Charcot is a benchmark in terms of equipment, designed to reduce the impact on the environment.

RECYCLED ENERGY

Blue Lagoon baths and benches on the promenade deck heated by recycled energy generated by the ship's propulsion

DRINKING WATER

Drinking water is produced directly on board using Nordaq technology, which enables bottling in glass containers

THE WORLD'S MOST POWERFUL AZIPODS

- 360° propulsion units for forward and reverse travel
- Exceptional safety and maneuverability in ice

HYBRID PROPULSION

- Use of liquefied natural gas (LNG) and electric batteries: up to -20% carbon emissions, -85% nitrogen oxide, and 95% fine particle discharge
- One of the few cruise ships in the world to be equipped with such a large battery bank
- The only ship in the world to be able to run on LNG for a month and a half, thanks to two 4,500 m³ tanks



VIRTUAL REALITY

Explore the ship in 3D and browse more content about onboard technology.

CONTROLLED ENERGY CONSUMPTION

Propulsion:

- Optimization of navigation routes thanks to custom-developed software
- Energy management systems
- Ship speed limitation

Hotel:

- Use of LED bulbs: -75% reduction in energy consumption

RECYCLING AND TRACEABILITY

- Glass, cardboard, hard plastics, and metal compacted, kept in cold storage, unloaded and processed by specialist companies
- Seawater treatment and recycling

AT DOCKSIDE

Use of dockside batteries to avoid atmospheric emissions

RESPECTFUL TOWARDS MARINE ECOSYSTEMS

- Bottom and sea creature detectors
- Electronic positioning system without the need for anchoring in protected areas
- Ballast water processing
- Reduced noise and vibrations

PC2 HULL

The only passenger ship in the world with a PC2 polar-class hull, ensuring safe passage through ice, inaccessible to other expedition ships. The most powerful ships are classed as PC1 (no passenger ships are included) and can operate in ice-covered waters throughout the year.



A popular visitor with the Greenlanders

Le Commandant Charcot, the only ship capable of reaching certain areas during the winter period, sometimes doubles as a supply ship for local communities. This role is part of PONANT's approach to sustainable development.

And suddenly, the silhouette of an approaching ship creates a stir in Tasiilaq. Especially when it's the first such appearance for many months. It is usually vessels bearing the Royal Arctic logo that bring enthusiasm out of the 2,000 or so people living here in this little town on Greenland's east coast. Between October and July, however, Tasiilaq is surrounded by ice, and the ships of the Greenland-based company are unable to deliver supplies by sea. It's then that *Le Commandant Charcot* puts on another hat. *"Having deliveries in May, which is more than two months earlier than usual, is something undreamed of for the local people,"* states Captain Patrick Marchesseau, who was at the helm of *Le Commandant Charcot* when it first delivered supplies - free of charge - to Tasiilaq and Ittoqqortoormiit in May 2023.

Also present that day was Justus Hansen, who remembers a welcome from his people that went beyond merely warm. *"At this time of year, foodstuffs generally arrive by plane, which drives up prices. You can expect to pay €3 for an apple for example, whereas they cost around 50 centimes when delivered by ship,"* explains the man who, as a local elected representative, is one of the initiators of the project.

ALWAYS A "HAPPY DAY"

The logistics involved are now running like a well-oiled machine, with goods (fruits, vegetables, and dairy products) arriving at the port of Reykjavík by lorry. Packaged on pallets, these tons of foodstuffs are then loaded into the holds of *Le Commandant Charcot*, which serves as the link to Greenland. *"This gives this ship an even greater sense of purpose,"* says Captain Patrick Marchesseau, who never tires of watching the flurry of snowmobiles and the many people busying themselves helping with the unloading; taking care, as they do so, to only take with them the minimum amount of plastic needed to keep things preserved. A few hours later, the first supplies are on sale in the local supermarket. Here too, the impact will be felt the moment the store opens. *"A real day of celebration,"* concludes Justus Hansen.

A STORY TO BE WRITTEN OVER THE LONG TERM

- First supply of provisions to **Tasiilaq**, May 5, 2023: **10 pallets** delivered - almost **four tons** of food.
- Second supply of provisions, May 15, 2023: **24 pallets** delivered.
- Between visits in May 2023 and May 2024, **over 40 pallets** have been unloaded in **Ittoqqortoormiit**.
- **And the future?** The project is set to continue for the next few seasons in periods when Royal Arctic is unable to deliver supplies. It will also be extended to other communities, notably in western Greenland.



1. Le Commandant Charcot in Tasilaq Bay, May 2023.
2. Justus Hansen, local community representative (Tasilaq).

3. Captain Patrick Marchesseau.
4. Unloading in Tasilaq, May 5, 2023.



“Because the circle of life is of crucial importance for us.”



Jaakusaaq Sørensen, nature spirit

In May 2023, PONANT launched a program to train young people from the Inuit villages we visited to become expedition guides. The first to give it a go, Jaakusaaq Sørensen, shared the history and culture of the Inuit with the guests of *Le Commandant Charcot*. For them, it was a way of experiencing their trip from a different perspective. For Jaakusaaq, it was an opportunity to shed light on his community's philosophy and traditions.

On first meeting him, you get the impression of an adult who is somewhat ill at ease in his tall, slim body. Yet his shyness and reticence disappear when your eyes meet his, with their piercing gaze that unwaveringly holds that of everyone he speaks with. It's easy to forget that Jaakusaaq Sørensen is barely in his twenties. And you listen to him. Reverently. Thus it was that this biology student had the opportunity to don an expedition guide's tunic and convey his messages to both guests and crew of *Le Commandant Charcot*: *"For me, being here is important. And above and beyond the precautions to take when visiting our region, I like to explain the history of our land and the way we live, our way of life."* The backdrop to this is his commitment to Inuitism, a cause to which he admits being a latecomer, despite the denigration to which he was subjected during his youth when he was already rejecting a Christianity with which he did not identify.

FOR PONANT, A PRESENCE THAT COUNTS

To better understand the man who has lived all his life in Tasiilaq, we need to understand the significance of a spirituality that is undeniably centered on nature. And which reveals its full meaning when he recounts the legend of Imap Ukua: *"Promised to a stranger, this young girl soon realized that a raven was in fact hiding behind*

his mask. She then fled in a kayak with her father who, realizing it was impossible to escape from this creature, cut off his daughter's fingers as she clung to the boat to keep from sinking." Welcomed by the Ocean, Imap Ukua became the 'mother of the sea,' recognizable by her very long hair. *"When we behave badly, her hair turns into nets that keep animals captive, thus depriving humans of food,"* recounts Jaakusaaq. The message: nature is the most precious thing on Earth, and we owe it to ourselves to show it respect and humility. The budding guide defends these values and does his utmost to perpetuate them. He advocates responsible hunting where even the bones must be reused, *"...because the circle of life is of crucial importance for us."*

And what about *Le Commandant Charcot's* passage through his home town? *"More than a nice gesture from PONANT and the fresh supplies it brings [read our article on page 20], above all it brings people, meaning there's a presence here earlier in the year,"* he says with satisfaction. And in turn, the ship's expedition leader, Steve Moir, takes a positive view of Jaakusaaq Sørensen's presence: *"It's important to have young Greenlanders on board. It's a way of paying tribute to the communities we visit."* And of continuing to deliver powerful messages.

THE TRAVELER'S CODE OF ETHICS

Each of us can contribute to building a better world. Traveling aboard *Le Commandant Charcot* means committing to leaving a minimal footprint, in line with the values we defend and share in this code of ethics. In polar regions, the expedition team will provide you with guidance for ensuring compliance with the IAATO and AECO regulations, the organizations that govern these regions.



BEFORE THE TRIP

- ✓ Take an interest in the destination and find out about its inhabitants – their customs and practices – its wildlife, culture and history, setting aside all prejudices and preconceived ideas
- ✓ Only pack the essentials
- ✓ Ensure compliance with the prohibition on the import of forbidden products

DURING THE TRIP

Leave no lasting signs of your visit

- ✓ Do not leave litter on site
- ✓ Do not move anything or remove anything from the places visited (sand, stones, bones, plants, etc.)
- ✓ Do not carve on rocks, ruins, or buildings
- ✓ Avoid trampling on the vegetation

Do not disturb the wildlife

- ✓ Keep conversation low and move slowly
- ✓ Comply with the minimum distance guidelines
- ✓ Leave all food on board the ship
- ✓ Give right of way to the animals when they're on the move and accessing water



Show respect to the communities

- ✓ Behave in an open manner
- ✓ Adapt to the local customs
- ✓ Ask before taking photographs
- ✓ Do not walk in gardens, cemeteries, remains, or other archaeological sites, and do not look into the windows of dwellings unless invited to do so
- ✓ Contribute to the local economy by purchasing craft souvenirs (unless they contain feathers, fossils, bones, plants, and stones; ask the naturalist guides for advice)

Comply with the security guidelines

- ✓ Listen carefully to the instructions issued by the crew and expedition team
- ✓ Stay on the signposted footpaths
- ✓ Follow the group
- ✓ Do not interact with guides responsible for bear watching
- ✓ Dress appropriately for the climatic and landscape conditions
- ✓ Know and respect your physical limits

AFTER THE TRIP

- ✓ Share your experience with others
- ✓ Raise the awareness of your friends and family and encourage them to get involved
- ✓ Continue to keep up-to-date on the regions visited

POLAR SCIENTISTS

From her inauguration in September 2021, *Le Commandant Charcot*, with her two laboratories, has set sail with teams of researchers to fulfill the specific ambition of the PONANT Science program: to further scientific knowledge of the polar regions. Vladislav Sidorenkov-Duprez, Program Coordinator, and Éric Dupont, Science Officer, take stock of the first three seasons.

Understanding to inspire

"Do you know the company motto? Explore to Inspire. I often tease my colleagues by saying that exploring is fine, but understanding is even better," Éric Dupont quips. *"It's possible with a ship like this. The PONANT Science project is playing an important role in furthering our knowledge of these remote territories and raising awareness of our impact on the planet."*

335

...square feet on board *Le Commandant Charcot* are allocated to research, including *"...a wet laboratory (with water intakes in the hull to take water samples), a dry laboratory, and a computer server room,"* Vladislav Sidorenkov-Duprez details. *"This is probably the only ship in the world to offer this kind of service on a regular, ongoing basis. It visits locations that are difficult to study due to a lack of terrain data. An opportunity for scientists,"* adds Éric Dupont, who coordinates the scientific projects on board. Researchers are keen to talk to guests, and their stays on board are often notable for laboratory visits, lectures, and informal discussions.



Did you know?

The European association ARICE (Arctic Research Icebreaker Consortium), funded by the European Commission, is leading the calls for projects initiated by PONANT. Made up of experts from the international scientific community, it assesses applications according to two main criteria: the quality of the project and the associated scientific research program, and also the impact on society.

"We send them our itineraries, departure dates, the number of staterooms available and ARICE has almost carte blanche," explains Vladislav Sidorenkov-Duprez. As the seasons go by, a common thread emerges, namely the study of climate change. *"Of the 96 scientists on board, some are part of the Intergovernmental Panel on Climate Change,"* says the coordinator of the PONANT Science project.

Over 50 projects!

Between its launch in September 2021 and August 2024, *Le Commandant Charcot* provided the opportunity to host more than 50 projects, bringing together from the four corners of the planet 136 scientists with diverse specialities, including microbiology, climatology, palaeoclimatology, social sciences, and others. And, in September 2024, we look forward to welcoming 21 scientists on board at one time, as they work on 6 projects during our **Transarctic, Quest for the Two North Poles** expedition; the primary focus will be an analysis of microplastics.

120,000 nautical miles

Le Commandant Charcot covered 120,000 nautical miles in two years. That is the same as the number of data points collected by the autonomous measuring devices operating continuously on board (see details on page 28). *"Le Commandant Charcot is impressive because she is capable of going everywhere. She can withstand 10-meter waves, 65 knots of wind, and even make her way through ice... This allows researchers to launch their probes into areas where there is no field data,"* details Éric Dupont.

Under the sun of the Antarctic skies

How does living in constant daylight affect sleep? Mood? In August 2023, a team of scientists from Yale University boarded *Le Commandant Charcot* to study the impact of permanent sunlight on the bodies of guests and crew.

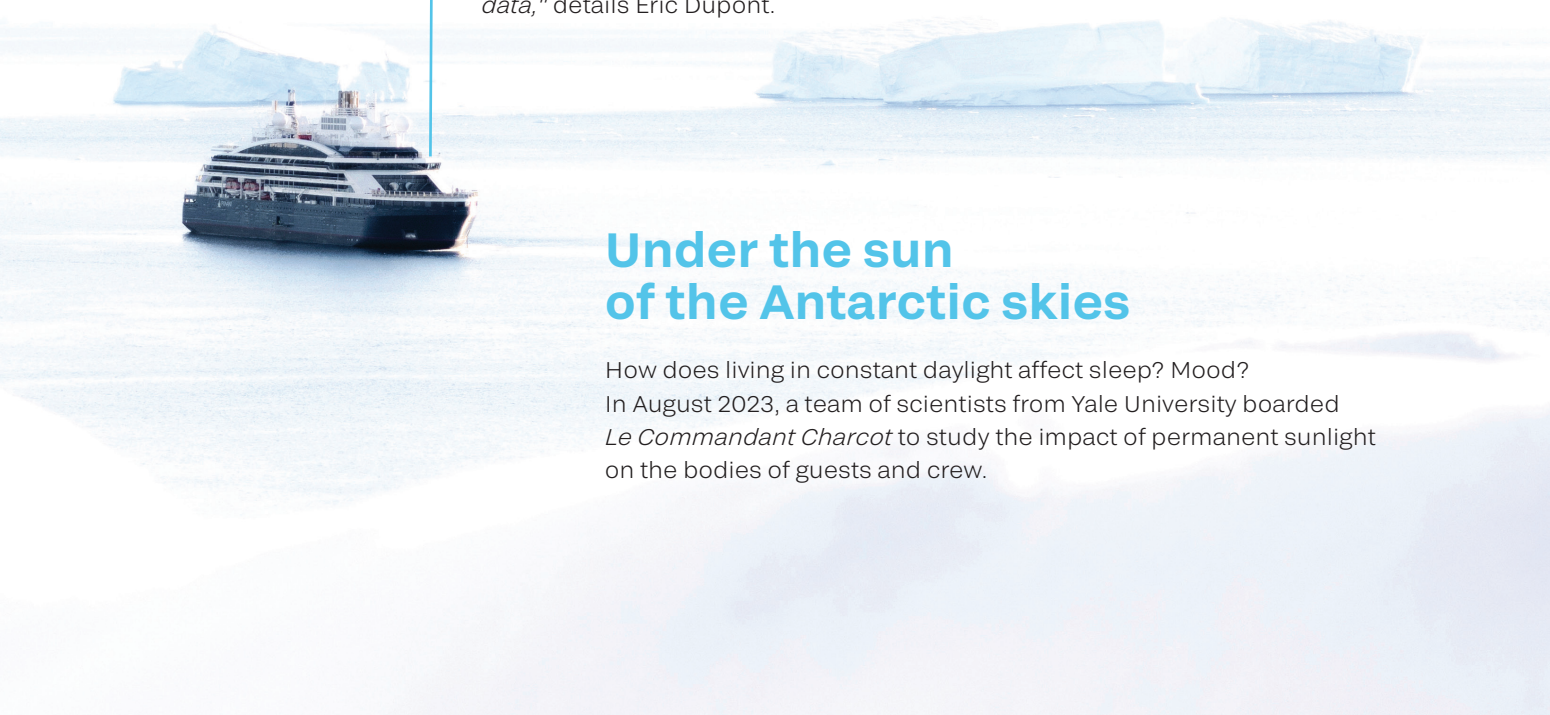

Sounding the oceans 24 hours a day

A FerryBox, a sophisticated system in the bowels of *Le Commandant Charcot*, constantly analyzes the surface seawater through which the ship sails. The information gathered provides information on the evolution of the oceans and the climate. Valuable data for the work of the international scientific community. Geoffroy de Kersauson, onboard scientific coordinator, explains the workings of this machine.

DISSOLVED OXYGEN PERCENTAGE SENSOR

This probe is assisting scientists to refine their knowledge of the amount of oxygen present in the waters through which the ship passes. This is an essential piece of data that is being closely scrutinized by the international community. The loss of oxygen upsets the crucial balance of marine life.

THERMOSALINOGRAPH

This element measures both the temperature and salinity of the waters crossed by *Le Commandant Charcot*. The aim is to study the 'thermohaline circulation,' an oceanic movement on a planetary scale resulting from differences in the density of seawater. This in turn depends on temperature and salinity. In the North Atlantic Ocean, this circulation is well known, namely the Gulf Stream.

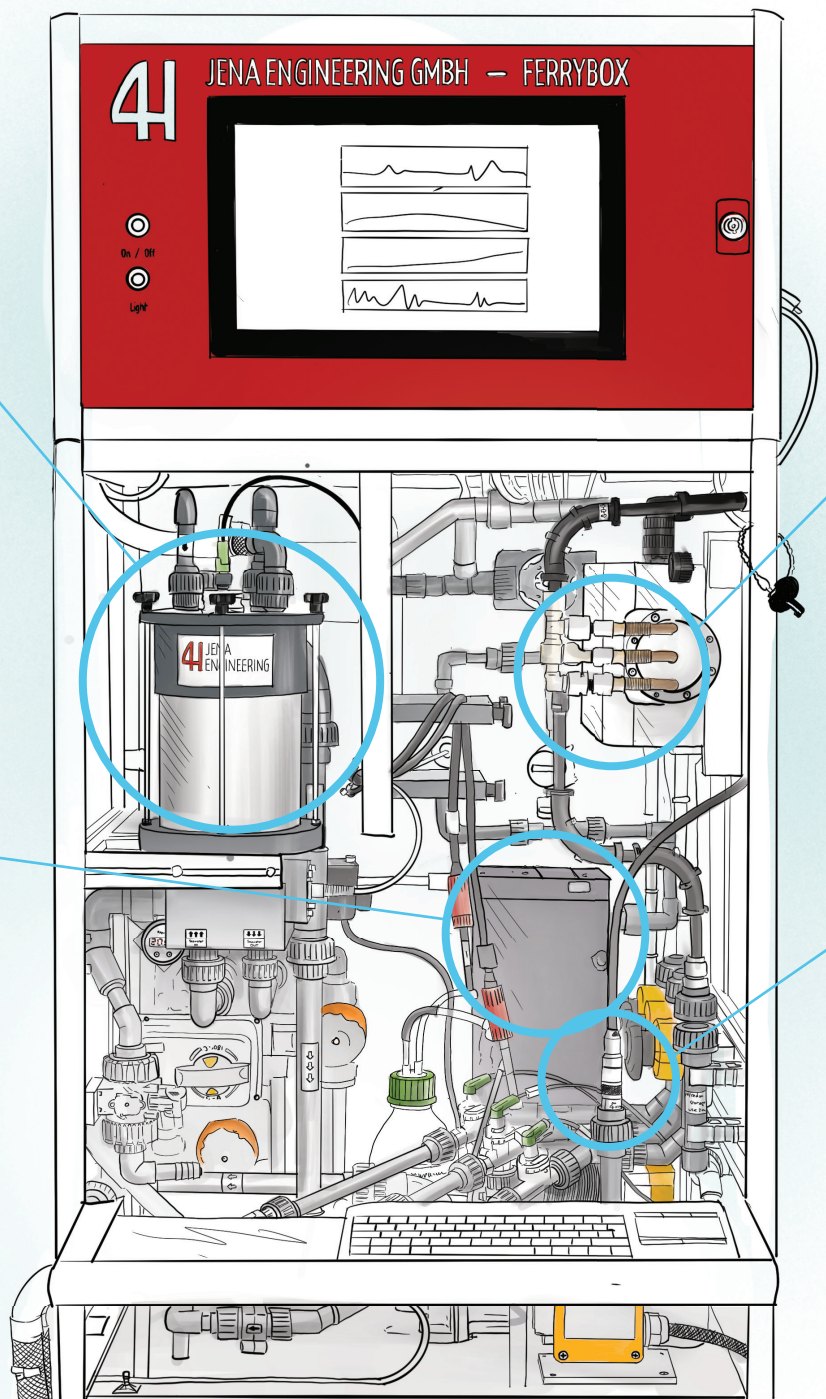

WHAT HAPPENS TO THE DATA COLLECTED?

During her first two years of travel, *Le Commandant Charcot* covered 120,000 nautical miles, with the same number of data points collected. As soon as the vessel is at sea, the FerryBox system turns on automatically and the information collected is stored on a local server. At the end of each voyage, the data is extracted and archived on a server on land.

CO₂ DETECTOR

Particular attention is paid to CO₂ and ocean pH in Antarctica. The ocean has always played a role in regulating the climate, in particular by capturing and storing CO₂ from the atmosphere. The problem is that the absorption of increased quantities of CO₂ by the world's seas is altering the marine carbonate cycle, which has an impact on the acidification of seawater.

PH SENSOR

At present, seawater has an average pH of 8.1. This has been declining since the mid-19th century. This acidification is amplified at the Poles. We are not sufficiently aware of how well organisms can adapt to this phenomenon. This unknown is a major issue for human beings since, in the long term, if plankton populations collapse, for example, it could have consequences for the amount of oxygen in the air we breathe.

Three questions for Geoffroy de Kersauson

What is your role as onboard scientific coordinator?

With the PONANT Science program, we welcome scientists on board *Le Commandant Charcot*, and they devote their time with us to intensive data collection. My role is to mediate between the laboratories and the bridge. I take stock of the researchers' needs on a daily basis and talk to the Captain so we can give them as much help as possible. For example, if they need to launch a probe, the ship has to be stopped for an hour. Is this compatible with the guest program? When and where?

The wet laboratory contains a machine that is constantly running... Can you tell us more about it?

The laboratory where the researchers take their samples also houses our FerryBox. The FerryBox takes its name from the first machines of this kind installed on ferries making the same journeys every day in northern Europe. The objective is to observe the changes in ocean data over time. The fact that *Le Commandant Charcot* is traveling the same routes in Antarctica and the Arctic is of enormous interest. This equipment provides a greater understanding of local dynamics and trends thanks to five data sets, known as the 'essential ocean variables.'

Who can access this data?

The whole point of PONANT Science is to ensure that as much of the data as possible acquired in these remote areas is made available not only to the scientific community, but also to the general public. The company is currently setting up a mirror server on land so that the public can consult all the data from the FerryBox, as well as the GPS, the devices that measure roll and pitch, the ice thickness measurement system, and so on. This is what is meant by open data.



The design of *Le Commandant Charcot* – conceived by Studio Jean-Philippe Nuel and Wilmotte & Associés architect's offices – reflects one guiding principle: to invite the polar environment on board. The result: spaces that are cozy yet open to the outside world, creating a feeling of wellbeing enhanced by the meticulous detailing that awakens all the senses.



Enjoy a unique experience on board
with our crew-to-guest ratio.





OUTSIDE

- Laze in the warm waters of the Blue Lagoon outdoor pool (heated to 27-37°C via energy recovery technology) and enjoy the breathtaking views.
- Settle into the outdoor bar *Inneq* ('fire,' in Inuit) to relax with a hot drink on the heated chairs.
- Stroll the end-to-end promenade deck, which allows you to make a complete tour of *Le Commandant Charcot* - a rare feature on a passenger ship.
- Take a break on one of the heated benches and observe the wildlife through Swarovski Optik spotting scopes.





INSIDE

- Enjoy a moment of relaxation in the Grand Salon in a warm, relaxed atmosphere.
- Access the Cigar Lounge, one of the ship's most exclusive areas, and indulge in a selection of fine cigars and premium spirits.
- Leaf through some of the many books dedicated to travel available in the *Anori* ('wind,' in Inuit) Observatory bar, while looking out at your vast white surroundings.
- Sit in the *Kita* ('let's go,' in Inuit) theater, a place to come together for music or dance performances, or lectures led by naturalist guides, experts, and distinguished guests.
- Stay in shape thanks to the top-of-the-range equipment in the fitness room and an onboard sports coach.





An onboard museum

On board, some 300 works by over 40 artists from a wide variety of backgrounds adorn different areas of the ship. Sculptures, blown glass, ceramics, photographs, paintings, digital art... All works are inspired by the materials and settings of the polar landscapes to bring you a truly immersive experience. Beginning in 2024, 50 of them will be integrated into the digital museum, accessible via the PONANT app. By scanning them, you can learn more about the creative processes and the biographies of the various artists represented.







WELLNESS & RELAXATION

- Enjoy the benefits of the cold in the Snow Cabin *Siku* ('snow,' in Inuit) following a treatment at the Spa *Nuan* ('well-being' or 'happiness') or the Sauna *Ikuma* ('burning heat').
- Relax by the indoor pool *Imaq* ('sea water') and contemplate the polar landscapes through the panoramic floor-to-ceiling windows, all while enjoying a fruit cocktail from the Detox Bar.
- Take advantage of the personalized services offered by the hair and nail salon that overlook the horizon.

Biologique Recherche offers a personalized skincare methodology; each treatment is unique. On board, you'll be offered follow-up care throughout your journey, with specific treatments tailored to skin weakened by extreme temperatures. The products are pure, concentrated, almost raw, blended into complex formulas to renew, soothe, and repair your skin.

1. Jérôme Lacressonnière and executive chef Florent Delfortrie.
2. Plate service at Nuna, the Alain Ducasse restaurant.
3. Lobster with butter sauce at Sila ("Heaven," in Inuit), the buffet restaurant.

Gastronomy

The one and only Alain Ducasse gourmet restaurant at sea, *Nuna* ('Earth,' in Inuit) takes you on a voyage to extreme environments with a menu of excellence specially designed by the Michelin-starred chef, as well as some of his signature dishes. In addition to this range of fine gastronomy, there is also a second restaurant and grill offering a daily selection of deliciously refined and healthy cuisine.

THREE SEASONS OF HAUTE CUISINE ON BOARD

with Jérôme Lacressonnière,
Director of Ducasse Conseil

How would you sum up the first few seasons of *Le Commandant Charcot* in terms of gastronomy?

Gastronomy on board *Le Commandant Charcot* is fascinating because we go to extreme destinations: the Arctic and the Antarctic. Through a combination of our experience, the lessons we have learned, the new products we have discovered thanks to the Inuit communities, and the guest feedback we have taken into account, we have been able to evolve certain recipes, create new ones, and use new products, always carefully sourced, to bring innovation and variety to our guests.





What are the values of this partnership that inspire you?

PONANT and Ducasse Paris share the same values of excellence, simplicity, and audacity. For example, guests can savor a salmon caught in Greenland, enhanced by know-how

and techniques in conjunction with the kitchen, dining room, and bar teams, to bring something new to the table and create a unique PONANT moment.

What are you doing in terms of offering excellent cuisine that also meets sustainable development criteria?

From the moment we create our recipes, we are conscious of the need to avoid wasting food. It's also important to offer guests fresh, local produce, thanks to the relationships we've been able to build with the communities themselves over the last three seasons. To take Greenland as an example, we can offer halibut or redfish caught locally and bought directly

from the fishermen. We then work with these products on board and introduce them to our guests. It's important to appreciate this land, it is part of our DNA. Sharing this 'glocal' vision means first and foremost having a global understanding of the standards set up between the Ducasse Paris and PONANT teams, but always with a local interpretation.

A complete package

Aboard *Le Commandant Charcot*, discover the secrets of French *savoir-vivre*. Allow yourself to be carried away between moments of relaxation, adventure, and discovery, thanks to all the services reserved for you on board.

SERVICES INCLUDED

- All inclusive from arrival to departure
- Fine dining in restaurants *Sila* and *Nuna*
- All drinks in restaurants, bars, and mini bars (excluding premium)
- Butler service for Owner's, Duplex, Privilege, and Grand Prestige Suites
- Group classes given by a fitness and wellbeing coach: Pilates, yoga, active walking on the promenade deck, meditation, aquagym (list to be confirmed on board)
- 24-hour room service
- Free and unlimited WiFi service on board
- Parties, shows, and other activities
- Zodiac outings and landings
- Excursions in each port of call (depending on itinerary)
- Lectures and information sessions on board with naturalist guides
- Parkas provided and rental of rubber boots
- Sports activities (depending on departure dates)
- Taxes for national parks and conservation areas







A TEAM

OF EXPERTS



WORDS FROM THE CAPTAINS

They alternate at the helm of *Le Commandant Charcot*. With a wealth of experience in polar environments, their expertise comes with a touch of magic. Their sensitive and entertaining commentaries will punctuate your travel days. Captains Garcia, Marchesseau, and Devorsine are already at the microphone to provide you with an introduction to your upcoming adventures.

"In December 2024, Le Commandant Charcot will head for the Gulf of Bothnia and the capital cities of the Baltic Sea, for ideal family voyages full of Christmas spirit. In March-April 2025, we'll be heading for the west and still icy coast of Greenland, perfectly suited to the capabilities of this great ship; here, we'll be forging links with Inuit communities as an extension of what we've been doing in the east of the country."



Captain Patrick Marchesseau

"Ice is a dynamic system, so every journey is different. Le Commandant Charcot is in tune with each season, tracking the break-up of the sea ice. In Antarctica, in November 2023 - earlier than ever before - we went in search of nesting emperor penguins. Our gentle approach gave us the chance to observe the colony as closely as possible, in accordance with environmental regulations; we're eager to try again in October and November of 2025. Understanding what polar winter means: this is the theme for next winter, which will be dedicated to exploring the first ice in the Arctic."



Captain Stanislas Devorsine



Captain Étienne Garcia

"By remaining in the Northern Hemisphere during the boreal winter of 2024-2025, Le Commandant Charcot will become a 'winter ship' and offer some great itineraries, from the Baltic Sea to Québec. The Northern Lights, Scandinavian countries under the snow, St. Lawrence River under ice... All these experiences are new to me too. It's a dream come true, and I'm really looking forward to it."

Passion, responsibility, and commitment: expedition in the blood

As a child, Florence Kuyper dreamed of becoming a farmer or an explorer. Adventure has always been part of her DNA. This Expedition Leaders for PONANT - for over a decade - share her vision of the profession, which is as exhilarating as it is demanding.



Florence Kuyper

As an accomplished Expedition Leader, Florence Kuyper anchors her role in a foundation of skills, experience, and unwavering responsibility. However, delving into the roots of her professional journey unveils a pivotal force: passion. In her case, this fervor takes a dual form— a profound love for people and an enduring affection for the polar regions.

Since her inaugural encounter with Antarctica more than two decades ago, Florence has remained steadfastly enamored with its natural decorations. “Ever since my first visit, I’ve been irrevocably in love with its landscapes. Ice in all its forms, colors, and textures makes for the purest art I can imagine.”

Beyond the ice, what makes the polar regions so attractive? “It’s often difficult to define, a latent feeling, akin to intuition...” When pressed, a few things come to mind that explain the appeal. “The beauty, so far removed from anything we know; the iconic animals; the extreme conditions, so out of proportion, and the challenge they represent for us humans.”

All of these easily describe the polar pull, though one of her favorite memories is based not in an extreme environment, but in a comfortable community. “One of the elders of the local Inuit we met had spent the winter knitting and making small objects. When the day came, she asked 10 women to join her and offered them what she had made. She took pleasure in giving these gifts; it was moving and such a culturally rich moment. This kind of meeting represents a unique opportunity to break out of the ethnocentrism of our Western societies.”

The guests who joined that excursion no doubt left their adventure feeling more connected to both this community, and the remote wilds flung across this earth. Florence has observed that guests often rediscover a sense of wonder and reconnect with nature. “To best defend what we know and love, I hope our guests will get involved and become ambassadors for our planet and the polar regions.”



MISSION: HELPING YOU TO DISCOVER THEIR WORLD

The fact that PONANT has made the creation of unique experiences its signature, is largely thanks to their know-how and knowledge of the regions and communities whose doors they know how to open. These are our tourist correspondents.



"PONANT approached us in 2022 to ask what activities we could offer at a time of year when no boats could get to Tasiilaq. At first, I was surprised. And then... I saw Le Commandant Charcot and realized this ship is different to the others. The company has a real desire to offer its guests something out of the ordinary, and it is with this shared objective that we work together. Our aim is to involve people from the region; it's important to us that visitors have the opportunity to meet

them and find out about their daily lives and unique culture. Traveling by dog sled is one aspect of our culture, and it is bound to be a memorable experience. The fact that the people of Tasiilaq are able to visit Le Commandant Charcot is a highlight that means a lot to them, and I hope that this opportunity will come around again."

Line Kristiansen,
founder of Sermilik Adventures in Greenland

"PONANT will be offering the first crossing on the St. Lawrence River in winter, aboard Le Commandant Charcot. In fact, the whole program of activities we've devised for the company is totally exclusive! By calling at the five ports of Gaspé, the Magdalen Islands, Saguenay, Sept-Îles, and Québec City, we are opening the doors to the First Nations and the communities that live there, such as the Mi'kmaq and the Innu, who really delight in sharing. The guests who travel with us will have the opportunity to try out canoeing and ice fishing, see

Montmorency Falls, the Valley of the Ghosts, and even chat with the Innu over local delicacies before, for some, sleeping in a tent. These are moments when time seems to stand still. Being able to share these magical experiences is thanks to the local teams working in the various ports."

Annie Lalande,
Director of Operations
for Destinations North America in Canada



POLAR ACTIVITIES

Challenge yourself and prepare to be thrilled



Our teams work tirelessly to provide the best experience for our guests, and that includes offering the most immersive activities in the poles. Our highly qualified specialists will accompany you, ensuring safety and adventure go hand-in-hand.



SEA KAYAKING

Kayaking grants the opportunity to get closer to nature while gliding in pristine waters.



DOG SLEDDING

Traveling by dog sled is a daily occurrence for those living in Greenland; join local mushers for a ride.



SNOWSHOEING

Circle the ship's perimeter or go for longer walks with our naturalist guides leading the way.



NORDIC TREKKING

An exclusive opportunity in Greenland; two days of Nordic skiing with one night camping.



POLAR PLUNGE

A lightning immersion in 32° water requires only three things: your bathing suit, our safety rope, and a great deal of confidence.



ZODIACS

Cruising via Zodiac is a great way to get up close to the meandering coastlines and spot wildlife.

Polar Inclusions

Traveling on a polar expedition with PONANT means everything is taken care of, from meals and 24-hour room service, to gear that will help keep you warm and safe while exploring the elements.



PARKA GIFT

Every guest on board is given a complimentary parka.



SNOW BOOT RENTALS

Every guest on board is offered a complimentary boot rental.



NATURALIST GUIDES

Naturalist guides join all expeditions, sharing their expertise along the way.



ACTIVITIES
Immersion at the heart
of the Arctic.



ANTARCTICA





AN ULTIMATE
JOURNEY

The Emperor Penguins of Weddell Sea

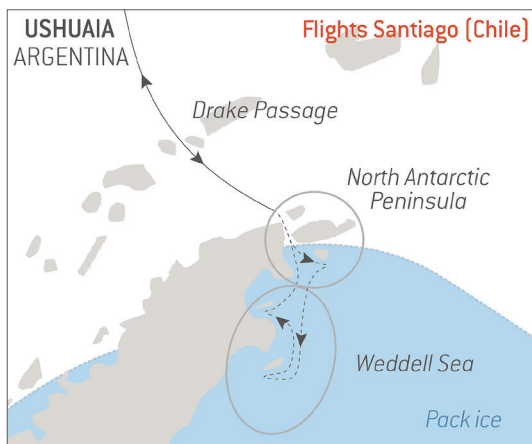

The home of the greatest expeditions, a refuge for the rarest wildlife, and an endless ice desert, the Weddell Sea promises an intense experience. This region is home to one of the most remote species on the planet, emperor penguins; you'll have multiple opportunities to search for these large, tuxedoed birds as you spend six full days exploring the waters of the Weddell Sea. Contrary to other penguins who live and nest on rocky outcroppings, emperor penguins nest on the ice floe, and this is where you're most likely to see this famous bird, waddling across the ice. As you navigate the Southern Ocean, you'll see ice in all its forms: tabular, bergy bits, pack ice, and glaciers all surround you on your voyage. Leopard and Weddell seals, humpback whales, and orcas will round out your wildlife viewing on this, most special of expeditions.



Ushuaia • Ushuaia

October 30, 2025 | November 11; 23, 2025

14 days / 12 nights on board

From **\$29,300** ⁽¹⁾

HIGHLIGHTS

- Venturing to the nearly inaccessible Weddell Sea, in search of majestic emperor penguins, as you sail past immaculate and dream-like landscapes.
- Observing landscapes including immense glaciers and table-top icebergs.
- Searching for wildlife including, Adélie, chinstrap, emperor, and gentoo penguins; crabeater, leopard, and Weddell; humpback and minke whales; orcas.
- Cruising via Zodiac on exploratory outings or shore visits with a reinforced team of naturalist guides.
- Learning from our expert guides through lectures and informal sessions both on board and on land.
- Joining workshops and lectures with our Photo Ambassadors, eager to help you capture all the best shots.
- Kayaking, hiking, snowshoeing - a variety of optional activities are available to you.

Included in your cruise ⁽³⁾: overnight in Santiago + flight Santiago/Ushuaia + transfers + flight Ushuaia/Santiago

In the Wake of Jean-Baptiste Charcot



"Legendary" is the most appropriate word for this expedition, as you'll be following the footsteps of iconic explorer, and your home-away-from-home namesake, Jean-Baptiste Charcot. An intrepid adventurer, he traveled far and wide in the polar regions, reaching the Bellingshausen and Amundsen seas in the early 1900s. Our journey provides a bit more comfort, but no fewer thrills than Charcot's. After navigating the Drake Passage, you'll cross the Antarctic Circle and head to Charcot Island, discovered by the man himself. As you continue south, you may see emperor penguins; when heading back north, the Peninsula is home to Adélie, chinstrap, and gentoo penguins. You'll also reach Marguerite Bay and Pourquoi Pas Island, the latter named for Charcot's ship. Throughout your expedition, you will be surrounded by ice, snow, mountains, and wildlife.



Ushuaia • Ushuaia

December 5, 2025 | January 2, 2026

16 days / 14 nights on board

From \$27,290 ⁽¹⁾

No single supplement ⁽²⁾

HIGHLIGHTS

- Visiting some of the least-known lands in the world: Charcot Island, Pour Quois Pas Island, and Marguerite Bay among them.
- Crossing the Antarctic Circle.
- Searching for wildlife including Adélie, chinstrap, emperor, and gentoo penguins; crabeater, leopard, Ross, and Weddell seals; humpback and minke whales; orcas.
- Observing landscapes including immense glaciers and monumental icebergs.
- Cruising via Zodiac on exploratory outings or shore visits with a reinforced team of naturalist guides.
- Learning from our expert guides through lectures and informal sessions both on board and on land.
- Joining workshops and lectures with our Photo Ambassadors, eager to help you capture all the best shots.
- Kayaking, hiking, snowshoeing - a variety of optional activities are available to you.

Included in your cruise ⁽³⁾: overnight in Santiago + flight Santiago/Ushuaia + transfers + flight Ushuaia/Santiago

Unexplored Antarctica between Two Continents

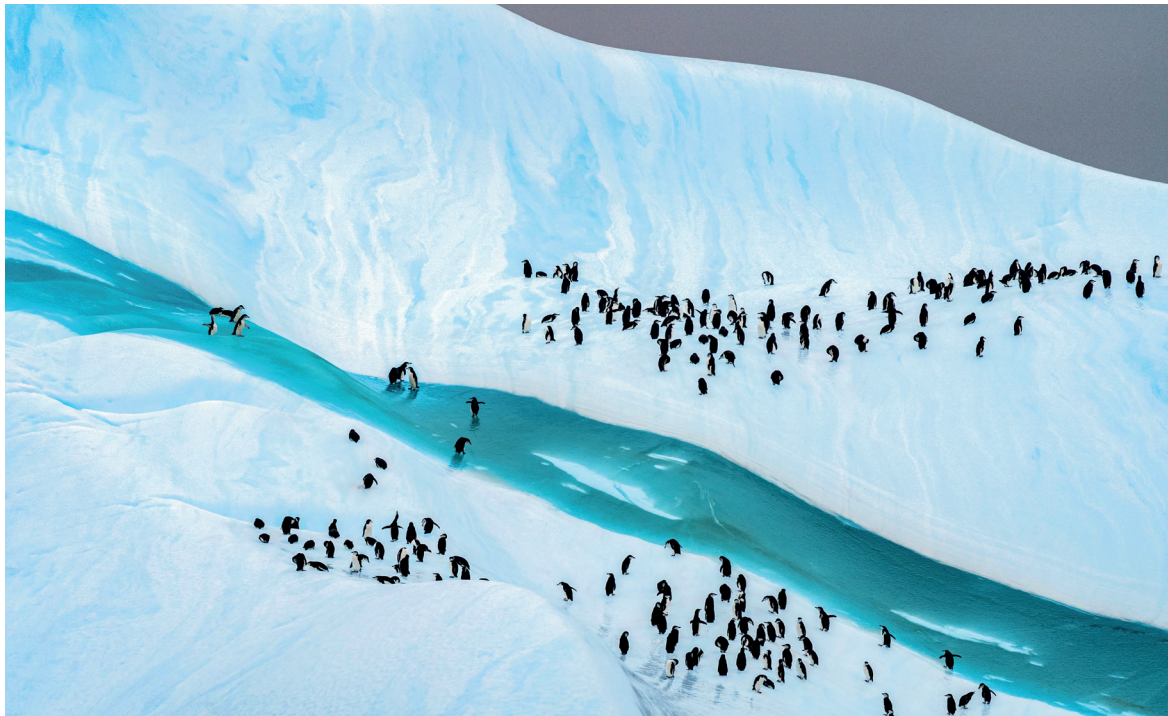

Charcot, Bellingshausen, Dean, Fisher, Ross, Amundsen... Aboard *Le Commandant Charcot*, the names of these legendary explorers resonate at every moment. Thanks to its unique capacity to sail into the very heart of the ice, we invite you to join us on board the world's first luxury icebreaker, and set off in the footsteps of these great Antarctic figures. This all-new, and unrivalled, half-circumnavigation sails from the world's southernmost city to Australia during a full month at sea. This journey to the boundaries of the known world will take you on a true adventure: to Charcot Island, namesake of your home-away-from-home and Marie Byrd Land, one of the last places on Earth considered "nobody's land." You'll navigate the southern seas of Bellingshausen, Amundsen, and most spectacularly, the Ross Sea, known for the extremely rare Ross seals. Join this once-in-a-lifetime expedition.



Ushuaia • Hobart

January 16, 2026

31 days / 29 nights on board

From **\$56,050** ⁽¹⁾

HIGHLIGHTS

- UNESCO World Heritage Site: Macquarie Island, a wildlife sanctuary and one of the subantarctic islands of New Zealand.
- Traveling alongside Jonathan Shackleton, descendant of Sir Ernest Shackleton and family historian.
- Half-circumnavigating Antarctica, an unforgettable experience deep into the heart of the ice.
- Crossing three southern seas: Bellingshausen, Amundsen, and Ross.
- Visiting some of the least-known lands in the world: Charcot Island and Marie Byrd Land among them.
- Searching for wildlife including crabeater, leopard, and Weddell seals; Adélie and royal penguins; humpback whales; orcas.
- Observing landscapes including ice shelves (including that of Ross), glaciers, and monumental icebergs.
- Learning about the history of the conquest of the South Pole, from the Bay of Whales, a natural harbour that served as a base for Roald Amundsen's victorious expedition in 1911.
- Cruising via Zodiac on exploratory outings or shore visits with a reinforced team of naturalist guides.

Included in your cruise ⁽²⁾: overnight in Santiago + flight Santiago/Ushuaia + transfers

Unexplored East Antarctica & French Southern Lands

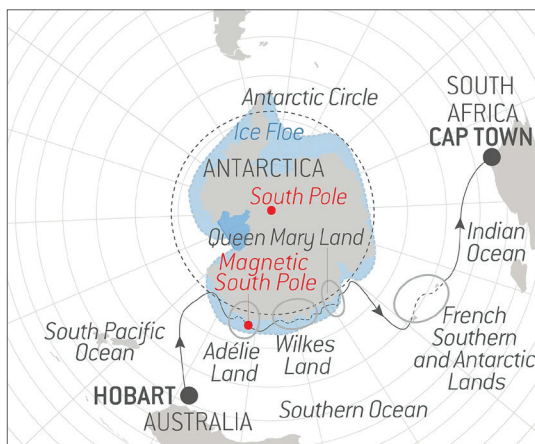

Many regions of the Great White Continent have been explored by legendary adventurers, but Eastern Antarctica remains relatively anonymous. On our month-long half-circumnavigation, you'll journey from Tasmania to South Africa, from the Pacific to the Atlantic Ocean, all aboard *Le Commandant Charcot*, an enveloping cocoon shaped for the highest polar latitudes. You'll sail past the largest polar icecap in the world, Inlandsis, and explore Australian research stations; visit Adélie Land, known for the eponymous penguins, as well as a variety of petrels; and search for the Magnetic South Pole. Sail alongside the Shackleton Ice Shelf, a 239-mile floating ice sheet attached to Antarctica, and search for emperor penguins on Queen Mary Land, a frozen kingdom of natural beauty. This expedition is the ultimate quest and promises unforgettable and novel encounters with one of the world's last remaining unexplored regions.



Hobart • Cape Town

February 17, 2026

29 days / 28 nights on board

From **\$52,210** ⁽¹⁾

HIGHLIGHTS

- Half-circumnavigatiing the eastern region of Antarctica, a brand-new expedition.
- Following in the footsteps of great explorers and sailors, such as Jules Dumont-d'Urville, Marc Marion Dufresne, James Cook, and Douglas Mawson.
- Searching for wildlife including Adélie, chinstrap, emperor, gentoo, and macaroni penguins; crabeater, elephant, leopard, Ross, and Weddell seals; humpback whales; orca; and a variety of albatross species.
- Observing landscapes including the largest polar icecap in the world, Inlandsis, a huge expanse of ice more than 10,000 feet deep.
- Cruising via Zodiac on exploratory outings or shore visits with a reinforced team of naturalist guides.
- Learning from our expert guides through lectures and informal sessions both on board and on land.
- Kayaking, hiking, snowshoeing - a variety of optional activities are available to you.

EXPERIENCE



SWAROVSKI OPTIK



SEE THE UNSEEN



THE ARCTIC

Disko Bay: Meeting the Inuit & Discovering the Unknown



During this immersion in the Greenlandic spring, you will discover the local communities of the country's west coast, whose villages are still encircled by the bordering ice floe. The harshness of winter gradually makes way for spring and the activities that go with it; life begins anew. Thanks to our special connection with the inhabitants of this fascinating island, PONANT offers an unforgettable experience. For four days, in Ilulissat and Qeqertarsuaq, you will enjoy learning the traditions and culture of the local Inuit community, from polar hiking, ice fishing, and dog sledding, to taking in their way of life and philosophy. In Baffin Bay, absorb your surroundings including massive icebergs and - fingers crossed - wandering polar bears. And in Prins Christian Sund, glide along the narrow channel that zigzags between the southeast and southwest of Greenland, leaving you breathless by beauty.



Reykjavík • Nuuk

March 21, 2025 | April 17, 2025

16 days / 15 nights on board

From **\$25,520** ⁽¹⁾

No single supplement ⁽²⁾



HIGHLIGHTS

- UNESCO World Heritage Site: Disko Bay, home to the largest icebergs in the Northern Hemisphere.
- Sailing through Baffin Bay along the southwestern coast of Greenland, and interacting with two local Greenlandic communities in villages that are only accessible to *Le Commandant Charcot* at this time of year, a PONANT exclusive.
- Searching for wildlife including polar bears, Arctic foxes, Ivory gulls, ringed seals, belugas, narwhals, bowhead whales, and more.
- Witnessing the enchanting spectacle of the Northern Lights (weather permitting).
- Learning from our expert, reinforced team of nature guides throughout your voyage.
- Kayaking, hiking, snowshoeing - a variety of optional activities are available to you.
- **March 21 Departure:** activities and lectures by an expert from The Explorers Club; workshops and lectures provided by a Photo Ambassador.

Included in your cruise ⁽³⁾: flight Nuuk/Paris + transfer

Encounter with the Last Guardians of the North Pole



Once again, *Le Commandant Charcot* opens the way to new horizons and invites you to experience a timeless odyssey. During this brand-new 13-day expedition, explore the frozen shores of the western Greenlandic coast and live like one of the last hunters in this region, one of the wildest and most remote places on the planet. The special moments spent with the community of Kullorsuaq, the hardest-to-access village in the region, will teach you about Inuit wisdom: powerful nature reigns supreme and encourages humility, as suggested by the Greenlandic word *imaqa*. Here, life thrives in the present moment and the notion of time and space is redefined.



Nuuk • Nuuk

April 5, 2025

13 days / 12 nights on board

From **\$23,690** ⁽¹⁾

HIGHLIGHTS

- UNESCO World Heritage Site: Disko Bay, home to the largest icebergs in the Northern Hemisphere.
- Spending four days with the Inuit community of Kullorsuaq, an icy environment and a PONANT exclusive.
- Traveling alongside explorer Nicolas Dubreuil, our Expedition Leader and an inhabitant of Kullorsuaq.
- Learning from local Inuit guides on board who are only too eager to share their ancestral knowledge.
- Searching for wildlife including narwhals, belugas, polar bears, Arctic foxes, ringed seals, Ivory gulls.
- Feeling the breeze in your hair as you enjoy a ride on a dog sled, still a common mode of transportation even today.
- Observing landscapes including ice floes as far as the eye can see, polar ice caps, and monumental icebergs.
- Joining workshops and lectures with our Photo Ambassadors, eager to help you capture all the best shots.
- Polar trekking, kayaking, overnighting in a polar camp on the ice floe—a variety of optional activities are available to you.

Included in your cruise ⁽²⁾: flight Paris/Nuuk + transfers + flight Nuuk/Paris

Jean-Baptiste Charcot – a Greenlandic passion



On the edge of the Arctic, the illustrious French explorer left an immeasurable legacy in his wake, guided by a passion for the world, a taste for passing on knowledge, and the grace of great men, as recounted by French expedition guide Cécile Manet.

At Ittoqqortoormiit, a village of 350 souls at the mouth of Scoresby Sound – the world's largest fjord system (see page 80) – the memory of Jean-Baptiste Charcot is still alive. Around the corner of a house, a French-language inscription pays tribute to this pioneer of polar navigation and to his comrades who disappeared off the coast of Iceland in 1936, after 10 years of a formidable odyssey to discover the shores of Greenland. The Inuit community was first established here nearly a century ago by Danish explorer Ejnar Mikkelsen who, in 1926, sailed to the Faroe Islands aboard the *Pourquoi Pas?*, the valiant three-masted ship of his colleague and friend, Captain Charcot. Having just been elected to the Academy of Sciences, Charcot, bitten by a nostalgia for the ice,

set off on a mission to the land of Jameson, which he reached with Mikkelsen's help via the island of Jan Mayen. He became the first Frenchman to reach the east coast of Greenland. "*His main objective, apart from science, was to sail along the coastline and carry out hydrographic work to make explorations safer,*" explains Cécile Manet, expedition guide and lecturer at PONANT.

EXPLOITS AND SOLIDARITY

While his expeditions were not necessarily marked by spectacular events, they represented an impressive accumulation of data. During his previous expeditions to Antarctica, almost 2,000 miles of coastline were surveyed, as well as an abundant collection of fossils, which contributed to the geographical and geological knowledge of the polar regions. Today, many of these archives (manuscripts, drawings, photographs, objects, etc.) form a treasure trove that is carefully preserved by the Muséum national d'Histoire naturelle in Paris. "*His courtesy, solidarity with his peers, dedication to his crews, and respectful attitude towards local populations earned him the reputation of the Gentleman of the Poles,*" Cécile points out. In 1928, during his second expedition to Greenland, he interrupted his work and sailed the Arctic seas to take part in the rescue of the seaplane Latham 47. He searched for the missing crew, which included the Norwegian explorer Roald Amundsen – one of his most famous contemporaries – to no avail.



Ammassalik region, May 2023.

One of his major achievements was the establishment of the Scoresby Sound scientific station as part of the 1932-1933 International Polar Year. Charcot and his men took part - with the help of the Danish authorities and the indigenous populations - in the reconnaissance of the terrain and the organization of operations, enabling France to maintain its place in the great tradition of exploration and scientific development. *"When I'm on board and I talk about him, I feel very small," says Cécile. "I feel a particular emotion when I visit the places he explored, imagining the conditions he faced. His self-sacrifice and the endurance of his crew have all my admiration."*

"MY LITTLE ONE, I'M TAKING YOU WITH ME"

Alongside Jean-Baptiste Charcot, the name of Paul-Émile Victor has become part of the legend of France's great polar explorations. It's the story of a happy crossover of destinies, between the illustrious navigator and the fiery ethnologist, 40 years apart. In 1934, Charcot, attracted by Victor's dynamism and determination, saw in him the next generation of scientists and took him on board his ship to set up the young man's first ethnographic mission in Greenland; a passing of the torch and the last elegant gesture of the 'Gentleman Explorer' before taking his leave.

Inuit Spring of Ammassalik

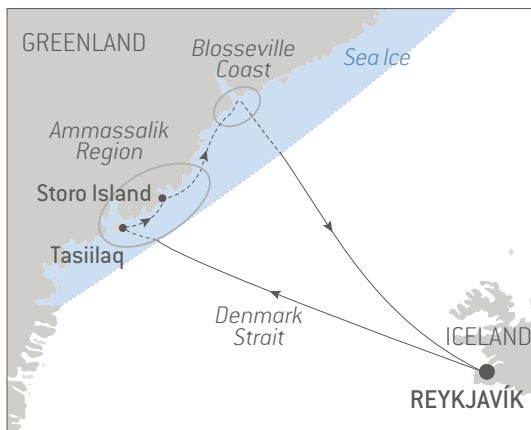

In Greenlandic, there is no future tense. Are you ready to embark on an adventure where only the present matters? As the polar night comes to an end, be the first travelers of the season to explore the remote areas of the eastern coast of Greenland in the spring sunshine: the legendary regions of Blosseville and Ammassalik, their shores still covered in a thick layer of ice. In these lands, which are inaccessible to traditional ships this early in the year, time and space seem to stand still. Take the time to marvel at these fascinating landscapes, icebergs trapped in sea ice, emerging glaciers, or hummocks made more beautiful by the play of light. Share authentic moments with the Inuit communities who live in harmony with the rhythm of the seasons and the ice, carrying on their traditions, such as hunting by dog sled. There, on the sea ice, amidst the icy vastness, the only thing that counts is the intensity of the experience, with others and with oneself.



Reykjavík • Reykjavík

May 4; 14, 2025 | May 4, 2026

11 days / 10 nights

From \$19,870 ⁽¹⁾

No single supplement ⁽²⁾

HIGHLIGHTS

- Discovering the spring traditions of the Inuit of the Ammassalik region and being transported during a dog sled outing, an activity designed with our hosts.
- Participating in a polar trek, a PONANT exclusive (view p. 72).
- Sailing along the Blossville Coast.
- Crossing the Denmark Strait.
- Exploring the region of Ammassalik, on board or on the ice floe.
- Searching for wildlife including polar bears; blue and humpback whales; seals; seabirds.
- Observing landscapes including ice cap, fjords, icebergs, calving glaciers, patches of ice floe.
- Learning from our expert, reinforced team of nature guides throughout your voyage.
- Joining workshops and lectures with our Photo Ambassadors, eager to help you capture all the best shots.
- Kayaking, hiking, snowshoeing, dog-sledding, ice fishing - a variety of optional activities are available to you.

Nordic skiing polar trek, an immersion in the heart of Greenland

Because PONANT's heart beats to the rhythm of the polar worlds and their inhabitants, our teams have come up with a uniquely immersive experience in the remote extremes of Greenland: Enjoy the opportunity to explore the authentic soul of the people of the 'Land of the Midnight Sun.'

- Two days of Nordic ski trekking and one night in a tent
- 10 guests accompanied by Greenlandic guides and a high mountain guide
- A unique opportunity to immerse yourself in Inuit culture
- An intense emotional experience in the immense, sheer beauty of the wilderness, at a time of year when only *Le Commandant Charcot* is present on site

Price: \$1,190 per person

Join the polar trek from the departure points on **pages 70-71**.

To take part in the polar trek, good physical fitness is required. There will be a compulsory ECG before departure, as well as a consultation with the onboard doctor. For more information, contact our travel consultants.

Our teams rose to the challenge

"The group grows stronger by the hour, as reflected by the anecdotes, songs, and smiles. We take our time to appreciate this moment suspended in time, here in northeast Greenland, several thousand kilometres from the landmarks we know. We are near the last inhabited village on this isolated coast. We share some very special moments with our Greenlandic guide, even though we don't speak the same language. I returned to the ship disoriented and shaken up by this expedition that took me outside my comfort zone, but enriched by this authentic human adventure, and above all, nourished by the powerful nature I encountered. It is a reminder that we are just passing through, that we need to adapt, to make ourselves small, and allow it to welcome us for a short while."

Diary of **Mégane Di Stefano**,
Product Content Manager at PONANT

A small step on skis, a giant leap for the adventurer...

"Nordic skis allow the wearer to glide, so the effort of walking is much smoother and softer. One step on a ski is almost the same as two steps walking. Like a snowshoe, Nordic skiing slightly increases the load-bearing surface. This means that you don't sink in as much, as a result of which, you can move more smoothly on snow-covered terrain."

Ludovic Gaboriaud,
high mountain guide at PONANT



After crossing the Denmark Strait, we reached the pack ice. In the heart of the ice, everything seems much quieter, and the human world far away. Arriving opposite Tasiilaq, very close to the Arctic Circle, seems unreal. The ship arrives silently, facing the village and its colorful cottages; tones that contrast with those of a raw and implacable nature. A man, who looks as if he has just returned from a long walk across the frozen land, pulls his pulka... All is calm and peaceful.

Tasiilaq – spring awakening

After the first few miles on the pack ice, *Le Commandant Charcot* stopped off in Tasiilaq to immerse those on board in the local life of an isolated village in eastern Greenland. A guest's diary.



Very quickly, a lively atmosphere developed around this ship. It has to be said that we are the first visitors of the year to disembark in Tasiilaq, which has been isolated for several months. Unloading fresh produce [see page 20], a tour of the ship for the locals and a tour of the village for the guests, followed by a traditional show on board: this was a real immersion in Greenlandic Inuit culture.

PORTFOLIO



Tasiilaq, a village of almost 2,000 souls, wakes up to the spring sunshine. In the shop promoting local crafts, a dozen or so women and men are busy in the dust. They are cutting, carving, and sanding reindeer antlers or seal bones. In just a few hours, they produce statuettes, some of which – tupilaks – are an integral part of Greenlandic folklore. In the past, these polymorphous figurines inspired by polar animals such as bears, seals, and walrus were created by shamans and had the power to destroy a targeted individual.

The next day, a few kilometres from the village, we wake up to the sound of barking. An endemic species, Greenlandic dogs have been used for centuries in teams to hunt bears and seals. Today, they offer us an immersive ride between snow-covered mountains and ice deserts. As teenagers, the Inuit are given several dogs by their father or uncle to look after. It's a sign of trust and a lifelong commitment.





Ice fishing is also an age-old activity, and continues to provide fresh fish to the people who live on the pack ice for much of the year. An auger, a fishing rod, a lot of patience, and that's it! On the menu: halibut, which will be cooked by the onboard chef.

Northeast Greenland's Unexplored Sea Ice



Let us guide you to one of the most inaccessible regions of the Far North. As spring draws to a close, while the ice and snow are still omnipresent in the early Arctic summer, you will explore particularly inhospitable areas, getting closer to their unspoiled shores. Like a polar treasure hunter in a kayak or on snowshoes, your eyes will scan the mountainous terrain, identify jagged ridges, the pinkish sparkle of the ice crystals, and marvel at the immaculate landscapes you have crossed. Beyond the Ittoqqortoormiit region, the solid and powerful sea ice controls visitors who dare to venture so far. As you head for northeast Greenland, you'll be sailing through drift ice. The blue-tinged crests of the icebergs are revealed in the light, and, if you're lucky, you may catch a glimpse of the graceful outline of a blue whale at the mouth of a fjord.



Reykjavík • Reykjavík

May 24, 2025 | June 7, 2025 | May 14, 2026

15 days / 14 nights on board

From \$26,030 ⁽¹⁾

No single supplement ⁽²⁾

HIGHLIGHTS

- Exploring the coasts of Blosseville and northeastern Greenland, an untouched remote region in the early Arctic summer, amid the ice carried along the Transpolar Drift.
- Crossing the Denmark Strait.
- Exploring the region of Ittoqqortoormiit, where the last hunters of the polar region live, at the entrance of Scoresby Sound, the world's largest network of fjords.
- Observing landscapes including fjords, glaciers, icebergs, polar ice cap, and hummocks.
- Searching for wildlife including polar bears; blue and humpback whales; narwhals; seals; muskoxen; Arctic foxes; orcas; and seabirds.
- Learning from our expert, reinforced team of nature guides throughout your voyage.
- Joining workshops and lectures with our Photo Ambassadors, eager to help you capture all the best shots.
- Kayaking, hiking, snowshoeing, dog-sledding, ice fishing - a variety of optional activities are available to you.





SCORESBY SOUND

A UNIQUE ECOSYSTEM AT A LATITUDE OF 70° NORTH

Known as the largest fjord system in the world, Scoresby Sound owes its name to the English scientist William Scoresby, the first explorer to map this desert of ice, in 1822. Focus on this extraordinary Greenlandic environment.



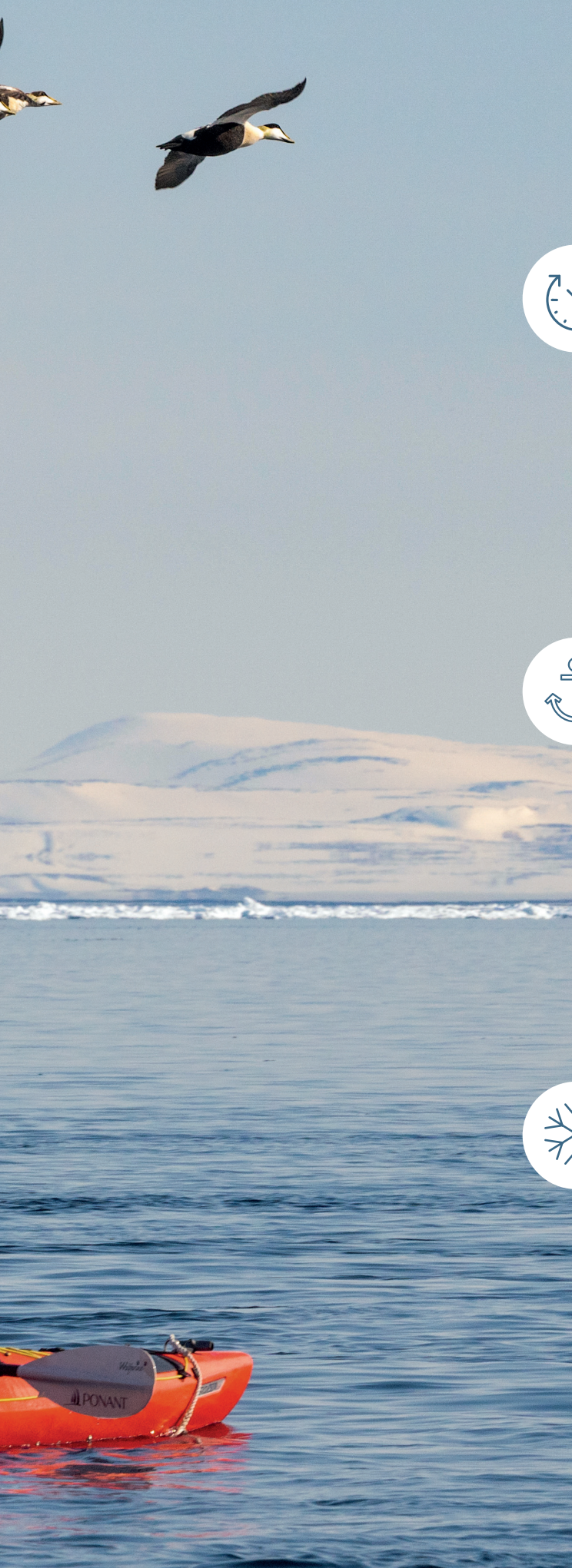

DARKNESS AT NOON



Located at the entrance to Scoresby Sound, at a latitude of more than 70° North, the town of Ittoqqortoormiit is plunged into a long polar night and does not see daylight for more than five months of the year. Daylight re-establishes itself here, culminating in the Midnight Sun from May onwards, when *Le Commandant Charcot* takes you there.

AND WHY NOT?



Being fascinated by the Arctic, the French explorer Jean-Baptiste Charcot visited Scoresby Sound eight times between 1925 and 1936. He explored the entire eastern coast of Greenland aboard his three-masted schooner, the *Pourquoi Pas? (Why Not?)*. Following in the footsteps of William Scoresby, he continued and expanded the mapping of the fjords; his work contributed to our understanding of the geography, wildlife, and culture of the region, including towns such as Ittoqqortoormiit.

THE SOUND OF THE GLACIERS



During an expedition to Scoresby Sound in 2016, geophysicists set up a method based on acoustic and seismic studies, to understand the flow and melting mechanisms of glaciers in the light of global warming. The installation of geophones - devices that convert ground movement (velocity) into voltage - has made it possible to record and measure the hydrological activity of glaciers. The scientists found that the energy measured by frequency correlates closely with ice melt, depending on weather conditions - sunshine or cloud cover.

Approach the immensity of Scoresby Sound during the itineraries presented on pages 78-79 and 82-83.

In the Ice of the Arctic – from Greenland to Svalbard



Push the limits of polar exploration and head for the ice of northeast Greenland, inaccessible to traditional ships in early summer, before reaching the Arctic tundra of Svalbard. Following in the footsteps of the polar adventurers, you will pass through legendary places such as the Ittoqqortoormiit region, and some of the most remote and fascinating landscapes of the Arctic. Against a backdrop of snowcapped mountain peaks, you will sail past ancient fjords and cathedral icebergs, and cross the floes drifting from the North Pole. The constantly shifting sea ice reveals different facets enlivened by subtle plays of light. Heading eastward, you will reach Svalbard and its breathtaking polar scenery: from Nordaustlandet, the site of Europe's largest ice cap, and the majestic fjords of the Hinlopen Strait, glaciers, and basalt cliffs. You will also visit the nature reserve in southeast Svalbard home to numerous birds, Svalbard reindeer, and cetaceans.



Reykjavík · Longyearbyen

June 21, 2025 | June 13, 2026*

17 days / 16 nights on board

From \$35,660 ⁽¹⁾



HIGHLIGHTS

- **June 21** voyage is in alliance with The Explorers Club; one of their members will serve as Host of the trip, sharing their expertise and exhilarating tales from the field.
- Exploring the ice to the northeast of Greenland, inaccessible to traditional ships in late spring.
- Enjoying the Sørøst-Svalbard Nature Reserve, the second largest protected area in Norway.
- Sailing in the Hinlopen Strait, infiltrated by ice, from Spitsbergen to Nordaustlandet, Europe's largest ice cap.
- Observing landscapes including mountains patterned with multi-colored strata, fjords, glaciers, icebergs, ice floes, and tundra.
- Searching for wildlife including polar bears, walrus, Arctic foxes, Svalbard reindeer, whales, and seabirds.
- Learning from our expert, reinforced team of nature guides throughout your voyage.
- Joining workshops and lectures with our Photo Ambassadors, eager to help you capture all the best shots.
- Kayaking, hiking, snowshoeing - a variety of optional activities are available to you.

Included in your cruise ⁽³⁾: transfer from port to airport after disembarkation + flight Longyearbyen/Paris

The Geographic North Pole



Fascinating, legendary, mysterious, extreme, remote, inspiring... There's no shortage of adjectives to describe the Geographic North Pole. A patient quest, a slow ascent through landscapes frozen by the extreme cold, this voyage, inaccessible to traditional ships, is a major expedition. From Spitsbergen, head north to sail the waters at the Earth's edge, towards landscapes that change constantly thanks to the ice and the rays of light. From the outside decks or the Observatory lounge, watch this icy kingdom as you journey by, embrace its other-worldly nature, and search for the king of the north, the polar bear. Follow in the footsteps of Frederick Cook, Robert Edwin Peary, and Roald Amundsen, be one of the chosen few to dare to adventure towards the elusive - 430 miles from land.



Longyearbyen • Longyearbyen

July 22, 2025 | August 6, 2025

July 12; 27, 2026 | August 11; 27, 2026

16 days / 15 nights on board

From \$48,210 ⁽¹⁾

HIGHLIGHTS

- Being among the few people in the world to go in search of the Geographic North Pole.
- Enjoying the unique experience of sailing through the heart of the ice floe and discovering the endless variety of forms and states of the ice.
- Observing landscapes including ice floes, jagged mountains, steep-sided valleys, sheer cliffs, and gigantic glaciers.
- Searching for wildlife including polar bears, whales, seals, northern fulmars, and ivory gulls.
- Learning from our expert, reinforced team of nature guides throughout your voyage.
- Joining workshops and lectures with our Photo Ambassadors, eager to help you capture all the best shots.
- Kayaking, hiking, snowshoeing - a variety of optional activities are available to you.

Included in your cruise ⁽³⁾: flight Paris/Longyearbyen + transfers + flight Longyearbyen/Paris

WATCH
Behind the scenes
of this scientific project.



Transarctic – a scientific adventure

In September 2024, *Le Commandant Charcot* will embark on a unique itinerary, never before achieved by sea: crossing the Arctic Ocean via the Geographic North Pole. No fewer than 20 researchers will be on board to experience this historic exploration. Learning about the research projects of the onboard scientific mission will be core to the voyage.

On September 6, 2024, *Le Commandant Charcot* will embark on a historic voyage to cross the Arctic Ocean via the Geographic North Pole: A world first. At the highest latitudes, the ship of scientific endeavour will attempt to unlock some of the secrets of the regions it crosses. "We're building a journey where the process is reversed somewhat in that, here, science will become a vector, a driving force even," assures the man who will take command of it, Étienne Garcia. "Normally, *Le Commandant Charcot* takes up to four researchers on board. For this exploration, there will be around 20 of them," explains Vladislav Sidorenkov-Duprez,

coordinator of PONANT Science, a department developed by the company to take part in international scientific and ethnological programs. A team selected by an independent, international conglomerate of experts will join the adventure. "ARICE [Arctic Research Icebreaker Consortium], funded by the European Commission, is leading 95% of calls for projects initiated by PONANT. They select applications primarily on the basis of the quality of the proposed project, and the expected impact of the associated scientific research program," he adds.

In mid-June 2023, ARICE launched a major call for projects. "Rather than separate teams coming on board, it will be a single multidisciplinary project bringing together multiple specialities," explains Vladislav Sidorenkov-Duprez. The data collected during the exploration will be freely available for consultation, in accordance with the open data principle governing the dissemination of research on board. Another special feature is that, "For the first time, PONANT will be asking experts to lead one talk a day to help spread the scientific knowledge," says the coordinator of the PONANT Science program.



96 scientists have been welcomed on board since 2021.

A JOURNEY GUIDED BY SCIENCE

While this transarctic route is creating emotion in high scientific circles, it is also sharpening the minds of the sailors. *"A route never taken, a total ice itinerary... We're preparing for some surprising conditions. You can't rest on your laurels, you have to be prepared to constantly reassess the passage ahead,"* explains Étienne Garcia. He will be accompanied at the helm by Captain Patrick Marchesseau, his colleague and friend, *"An indispensable duo on a compelling voyage during which we will all gain experience together. One of us will have to be on the bridge at all times."*

During the crossing, Captain Garcia will set out in search of the two North Poles, Geographic and Magnetic. *"A real challenge, even with such a ship,"* he enthuses. *"The Geographic North Pole, the*

iconic 90 °N, extreme point, is relatively stable, being the axis of the earth. The Magnetic North Pole, meanwhile, is on the move, as it is linked to the Earth's magnetic field." The itinerary, shared with scientists, will also have to deal with the concentration of ice. *"Nothing can be taken for granted in this particularly dynamic environment. We're going to have to plan our route using satellite maps and optimize it according to the natural channels of open water. We'll be sailing through the drifting ice pack. This means that the ice is in constant motion and closes up almost immediately behind us,"* says the Captain. Sailors and researchers approach this crossing of the Arctic with the same humility: *"We cannot sail arrogantly in these areas. We realize how small we are in relation to our environment,"* says Étienne Garcia.

Transarctic – The Quest for the Two North Poles



Enjoy a unique experience at the top of the world! Following in the footsteps of Umberto Nobile, who was the first to cross the Arctic by air almost a century ago, experience a transarctic voyage on this unique sea route, inaccessible to other ships. On board *Le Commandant Charcot*, a ship of scientific opportunity, you will sail alongside a multidisciplinary international team on a polar research mission. From the legendary Bering Strait to the ice-covered lands of Svalbard, your ship will clear its way through the mesmerizing sea ice, amongst the sculpted ice of the Beaufort Sea and through open water channels in an attempt to reach the elusive Magnetic and Geographical North Poles. Alongside our expert naturalists, you will discover unique ecosystems, gain a better understanding of the polar landscapes and the challenges of their transformation, and become an informed witness to their beauty and fragility.



Longyearbyen • Nome

September 5, 2025

21 days / 20 nights on board

From \$52,980 ⁽¹⁾

With featured guest Laurence de La Ferrière, a modern-day adventurer and explorer who was the first French woman to reach the South Pole alone.



HIGHLIGHTS

- Being among the first people in the world to undertake a transarctic crossing and setting off in search of the Geographic and Magnetic North Poles.
- Discovering the research work of an onboard international scientific mission, comprised of more than 20 researchers, during lectures and round tables.
- Exploring Svalbard, from Europe's largest ice cap on Nordaustlandet in the Sørøst-Svalbard Nature Reserve, the second-largest protected area in Norway.
- Searching for wildlife including polar bears, walrus, Arctic foxes, Svalbard reindeer, and whales.
- Observing landscapes including icy shores, ice floes, mountains patterned with multi-colored strata, fjords, jagged mountains, glaciers, icebergs, sheer cliffs, polar ice cap, tundra.
- Learning from our expert, reinforced team of nature guides throughout your voyage.
- Joining workshops and lectures with our Photo Ambassadors, eager to help you capture all the best shots.

Included in your cruise ⁽³⁾: flight Paris/Longyearbyen + transfers + flight Nome/Seattle

WINTER





IN THE GREAT NORTH

Welcome to the heart of the long winter



The glaciated Far North is generally out of bounds to visitors during the winter season. José Sarica, Expedition Experience Director at PONANT, has helped design some groundbreaking voyages and tells us about his first scouting trip on the St. Lawrence River, in Québec, in the middle of a long winter. A close encounter with a fantastic adventure of discovery for the winter of 2024-2025.

How did the idea of exploring the Far North in winter come about?

We are lucky enough to have the unique capabilities of *Le Commandant Charcot* to call upon, which fully comes to the fore in the ice. In particular, she is capable of traveling to this part of the world that is usually inaccessible to passenger ships during the winter (because of the conditions of the ice). This is the only vessel able to tackle it safely, and allows us to open the way to a new form of exploration and to highlight isolated communities.

What kind of itineraries can we expect in winter aboard *Le Commandant Charcot*?

Our mission was to find places where it wasn't too cold, where the polar night still gave light, and where the outside temperatures remained tolerable so that guests could make the most

of the adventure. We've designed itineraries with shorter distances and stopovers over one or more nights, making it possible to take things slowly, to feel relaxed, and to contemplate, while also reducing our carbon footprint by 30%. We'll visit the Norwegian fjords, Finnish Lapland, the Baltic Sea or the Gulf of Bothnia, and of course Greenland and Québec, in the heart of the ice pack.

You know Québec well, having lived there for 18 years. What is it about the St. Lawrence River region that left a particular impression on you?

The province of Québec has two very contrasting faces, and between the colors of late summer and the thick white coat of winter, I totally lost my bearings. It was a magical experience. I realized that the true richness of the region becomes prevalent in winter, when nature takes over – and to which we have to humbly adapt.

What immersive experiences will be offered to travelers in this region?

We offer ice fishing (with, if the fishing is good, a *ceviche* tasting on the ice floe), guided hikes (on snowshoes, cross-country skis, or snowmobile) through immense boreal forests, dog-sledding, and kayaking excursions. Also, an overnight stay in a chalet, at the summit of Mount Valin, or in a tent, with the Innu community of Sept-Îles. You can also expect the experience of a complete change of scenery through contact with local communities, with whom guests can share life experiences that are deeply moving.



What do you consider to be the key moments of this trip?

Saguenay is the cornerstone of this exploration. *Le Commandant Charcot* settles in the ice, guests disembark right on the fjord's pack ice and from there, set off to enjoy a multitude of experiences with the locals.

How can you ensure an authentic experience that benefits both travelers and local communities?

It's the dialogue and exchanges that make all the difference. Our role is to prepare guests to leave their comfort zone and rid themselves of preconceived ideas. With the local communities, we discuss our mutual needs and desires, always with the utmost respect, and together we devise itineraries that will shed light on the incredibly rich environments, customs, and people. The arrival of *Le Commandant Charcot* in winter in this region is of such importance to the locals that some festivities will even be postponed by a few weeks to accommodate us.

What moved you most during the adventure?

This trip is a compendium of emotions. I remember laughing and even crying, experiencing near-meditative moments in the face of the grandeur of the elements. It was above all the encounters and, in particular, the one with an Innu hunter [*read page 100*] that touched me deeply. Sharing a caribou heart by the fire, in a tent in the middle of the snow-covered landscapes we'd just crossed, made me feel extremely privileged and grateful.

If you had to sum up this trip in one sentence, what would you say?

In Québec, we have a saying: "*There's not many places in the world where you can experience the cold with such warmth.*" That perfectly sums up the spirit of the trip.

The St. Lawrence River in the Heart of the Boreal Winter



DOCUMENTARY

Surprises, emotions, wonder: the scouting carried out by our teams in Québec, offers you an extraordinary experience, exclusive and unprecedented.



Embark on an exclusive odyssey along the St. Lawrence River: a PONANT exclusive voyage in the middle of the Canadian winter when the river remains inaccessible to traditional ships. From the coziness of *Le Commandant Charcot*, you can navigate through different types of ice and follow the changes in the enchanting landscapes, where nature reigns supreme: northern forests of immaculate conifers, snow-covered valleys, a sea of ice. On land, enjoy winter activities such as ice fishing, snowshoeing, dog-sledding, and, if you're lucky, you may spot the iconic caribou, elk, or black bears in their natural habitat. The bright colors of the fishermen's houses stand out against the harshness of winter. Whether it's the Québec welcome or encounters with the Innu community, according to the Saguenay proverb, *"There aren't many places where you can experience the cold with so much warmth."*



Saint Pierre and Miquelon • Québec

January 17, 2025 | February 10, 2025

13 days / 12 nights on board

Québec • Saint Pierre and Miquelon

January 29, 2025 | February 22, 2025

13 days / 12 nights on board

From **\$24,210** ⁽¹⁾

No single supplement ⁽²⁾

HIGHLIGHTS

- Exploring the St. Lawrence River in winter, a PONANT exclusive: a journey uniquely possible aboard *Le Commandant Charcot*, capable of sailing in the sea ice of the river during this time of year.
- Meeting and learning about Québécois, the Innu, and Micmac indigenous communities.
- Witnessing the enchanting spectacle of the Northern Lights.
- Observing landscapes including great open spaces, fjords, immaculate boreal forests, sea ice, snow-covered valleys.
- Learning from our expert, reinforced team of nature guides throughout your voyage.
- Joining workshops and lectures with our Photo Ambassadors, eager to help you capture all the best shots.
- Kayaking, ice fishing, dog sledding, polar climbing, ice canoeing - a variety of optional activities are available to you.
- **February 10, 22, 2025 Departures:** the chance to watch whitecoats calving in the Magdalen Islands, the only place in the world where you can observe this unique spectacle.

Included in your cruise ⁽³⁾: flight Saint Pierre and Miquelon / Montreal or vice versa + transfer

SPOTLIGHT ON THE AURORA BOREALIS

The first written record of an *aurora borealis* dates back 3,000 years. Since then, from one century to the next and from one culture to the next, these strange celestial lights have never ceased to fuel imaginations, myths, and legends. These enchanting, luminescent tapestries that undulate across the northern sky are 100% natural.

NORTHERN LIGHTS

Solar wind particles colliding with the Earth's magnetic field.

4 DAYS

The time needed for solar particles to travel the 93 million miles separating the Earth from the Sun at an average speed of 280 mi/s.

THE BEST 'OBSERVATORIES'

Greenland, Finland, Norway, Iceland, Alaska, Canada.

THE SOUND OF LIGHT

Auroras that dance... and sing! They are said to produce almost imperceptible sounds, ranging from 'whistling' to 'crackling.'

10 TO 25 SECONDS

The exposure time needed to capture an *aurora borealis* with a camera.

WHAT STYLE!

Their shapes and colors vary according to the composition of the atmosphere.



FIRST "NORTHERN LIGHTS"

Whether the Italian astronomer Galileo in 1620 or the French philosopher and theologian Pierre Gassendi in 1649, who was the first to mention the *aurora borealis*? The issue remains divisive. However, it was in the 17th century that these mysterious luminescent phenomena came to be known as the *aurora borealis*; it was not until the aptly named Age of Enlightenment that the first elements of serious scientific analysis were introduced.

"ARCTIC ARTIST"

That's how she liked to define herself. Captivated by the beauty of the Norwegian archipelago of Lofoten, Swedish painter Anna Boberg (1864-1935) spent more than 30 full years here, summer and winter. Glaciers, the Midnight Sun, and the Northern Lights featured among her favorite subjects, such as her *Northern Lights. Study from North Norway*, exhibited in Sweden's National Museum, in which the *aurora borealis* becomes a marvelous, poetic, celestial symphony.

THE VALKYRIES RIDE

Luminous arches guiding the dead to the afterlife for the Inuits, fiery foxes running across the sky for the Finns, signs of ill omen for the Sámi, and for the Vikings, the Northern Lights were a reflection of the Valkyries' armor. These fearsome warriors were sent to Earth by Odin to recruit the best warriors and lead them to Valhalla for Ragnarök, the final battle and the promise of a new era.

Northern Lights can be seen on itineraries detailed on pages 64-65, 94-95.

From the St Lawrence to Greenland, the Last Moments of Winter

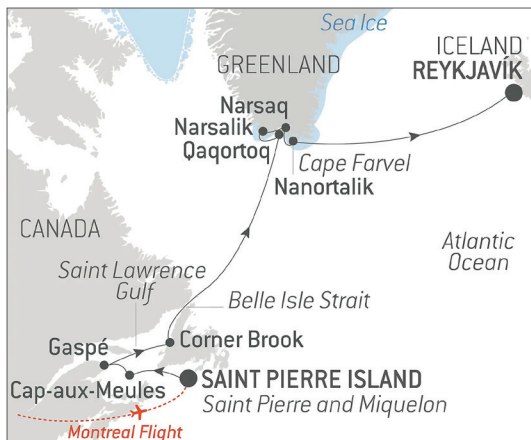

From the shores of the Gulf of Saint Lawrence, head to the southwestern coast of Greenland for an epic adventure. The Magdalen Islands offer a great start, with the opportunity to see young harp seal pups on the pack ice. As you leave North America, cross the Belle Isle Strait, home to caribou, humpback and minke whales, as well as harbor, grey, and ringed seals. In Qaqortoq, the largest town in southern Greenland, you'll find the typically rocky landscape covered in a white blanket, with brightly colored houses scattered and popping up. Throughout your journey, meet local Inuit communities, search for the wildlife that call this region home, and observe some stunning scenery, be it boreal forests, snow-covered valleys, or massive fjords. At the end of winter, take time to contemplate the dreamlike landscapes of the Far North and to let yourself be surprised by the unknown.



Saint Pierre and Miquelon • Reykjavík

March 6, 2025

16 days / 15 nights on board

From \$25,610 ⁽¹⁾

No single supplement ⁽²⁾



HIGHLIGHTS

- Sailing along both the Gulf of Saint Lawrence and the southwestern coast of Greenland in winter, a PONANT exclusive at this time of year.
- Interacting with the indigenous Micmac and Inuit communities.
- Searching for wildlife including moose, reindeer, caribou, wolves, polar bears, Arctic foxes, Ivory gulls, and Greenland seals.
- Observing landscapes including fjords immaculate boreal forests, ice floe, snow-covered valleys, and more.
- Polar hiking on foot or with snowshoes, fat biking, Nordic skiing, setting foot on the ice floe—a variety of optional activities are available to you.
- The possibility of seeing seal pups, commonly referred to as whitecoats, in the Magdalen Islands, the only place in the world where you can observe this spectacle.
- Learning from our expert, reinforced team of nature guides throughout your voyage.
- Joining workshops and lectures with our Photo Ambassadors, eager to help you capture all the best shots.

Included in your cruise ⁽³⁾: flight Montreal/Saint Pierre And Miquelon + transfer



The Innu: the thousand-year-old soul of Québec

Originally from the Labrador region and northeastern Québec, the Innu now number more than 27,000. Although little-known, they have existed for thousands of years. For the first time, guests on *Le Commandant Charcot* will get to know the Innu community of Sept-Îles during the winter of 2024-2025. José Sarica, Director of the PONANT Expedition Experience, went to meet them when he was scouting the area.

To get to Sept-Îles, in the northern Gulf of St Lawrence, José Sarica and his team first traveled by snowmobile through the unusual landscape of the boreal forest. *"We were surrounded by thick snow. The air was very fresh and dry. It gave us the sensation of feeling even more alive,"* he explains. But it was the contact with Chrystal Fontaine and her community that made the experience the most memorable: *"I realized at the age of 30, facing a caribou, that I was made to hunt,"* says this Innu woman, who learned to hunt with her husband. Thanks to him, Chrystal was able to be sure that she belonged to the Innu, although she initially thought of herself as Métis, another of Canada's Indigenous nations. *"I am Innu, my children are Innu, this is now fully part of our identity,"* she says, pointing to

the white leather canvas spread out in her tent. The caribou, an animal of vital importance to her culture, represents not only a means of keeping warm, but also a resource for food. *"We were served caribou heart soup, a very precious food, and there was something comforting about it,"* clarifies José Sarica. *"We were touched and truly living in the moment!"*

HARMONY AND SHARING

Rich in history and know-how, the Innu are keen to preserve their traditional way of life, in which nature plays an essential role: *"The smell of balsam fir as soon as you enter the small shelter pervades the senses, the warmth of the wood fire warms the soul, and the dawning Northern Lights make the moment even more magical,"* remembers José Sarica. The wonder and the harmony, and the full awareness of this being a special moment suspended in time, are the emotions felt unanimously by the PONANT scouting team, in the face of stories imbued with humility and the connection felt in these very human encounters. These sentiments are warmly shared by the Innu: *"We are happy to know that the world is interested in us, that we can showcase our culture. It's the best sign we could receive,"* says Chrystal, who plans to install tents to welcome PONANT's guests waiting to live this immersive experience. An exclusive winter stopover that promises to stir the emotions!



WELCOME ABOARD

Familiarize yourself with the ship,
her guest areas, and her various staterooms
and suites.



Deck Plans

DECK 9

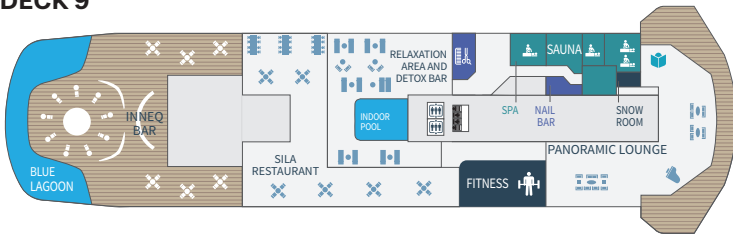

DECK 8

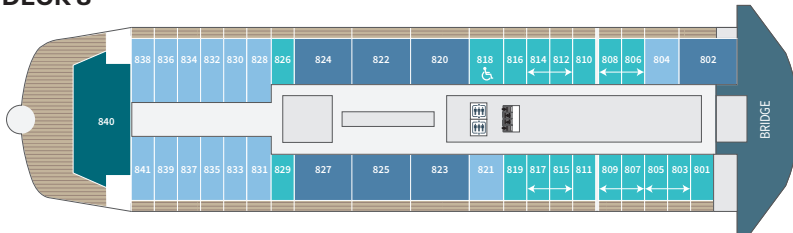

DECK 7

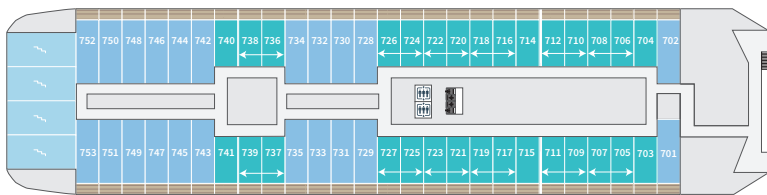

DECK 6

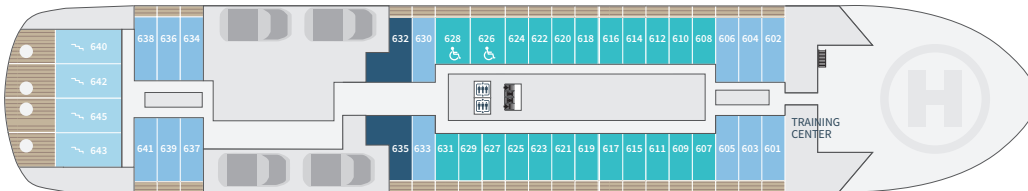

DECK 5

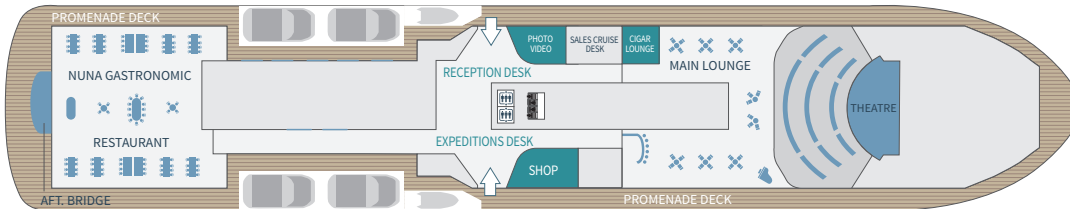

DECK 3

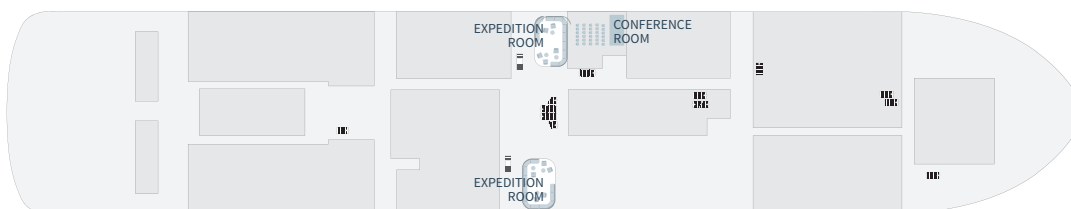

- Owner's Suite
- Duplex Suites
- Privilege Suites Deck 8
- Grand Prestige Suites Deck 6
- ↔ Prestige Suites Decks 7 - 8
- Deluxe Suites Decks 6 - 7 - 8
- Prestige Staterooms Decks 6 - 7 - 8



A virtual 360°
tour of
Le Commandant Charcot



Reception area



The Illu ('house' in the Inuit language) boutique



The Atrium, a digital creation by Miguel Chevalier

DECK 9

Sila Restaurant – Panoramic Bar and Lounge – Fitness – Biologique Recherche Spa (Snow-Room – Massage Rooms – Sauna – Nail Shop) – Hair salon by Davines – Detox Bar – Pools (one heated indoor pool and one heated outdoor lagoon pool) – Inneq open-air Bar – Library

DECK 8

Owner's Suite – Deluxe Suites – Privilege Suites – Prestige Staterooms (including one for person of reduced mobility and Prestige Staterooms convertible into five Prestige Suites) – Bridge

DECK 7

Deluxe Suites – Prestige Staterooms (including Prestige Staterooms convertible into Prestige Suites)

DECK 6

Duplex Suites – Grand Prestige Suites – Deluxe Suites – Prestige Staterooms (including two Prestige Staterooms for person of reduced mobility)

DECK 5

Nuna Gastronomic Restaurant – Theater – Main Lounge – Cigar Lounge – Shop – Reception Desk – Expedition Desk – Image & Photo Desk – Cruise Sales Desk – Promenade Deck – AFT bridge

DECK 4

Medical center

DECK 3

2 dedicated expedition boarding and disembarking rooms to port and starboard – Conference room

Discover your Stateroom

● Owner's Suite

115 sq.m/1,237 sq.ft +
186 sq.m/2,002 sq.ft
private terrace with hot
tub - balneo bathtub

360° TOUR

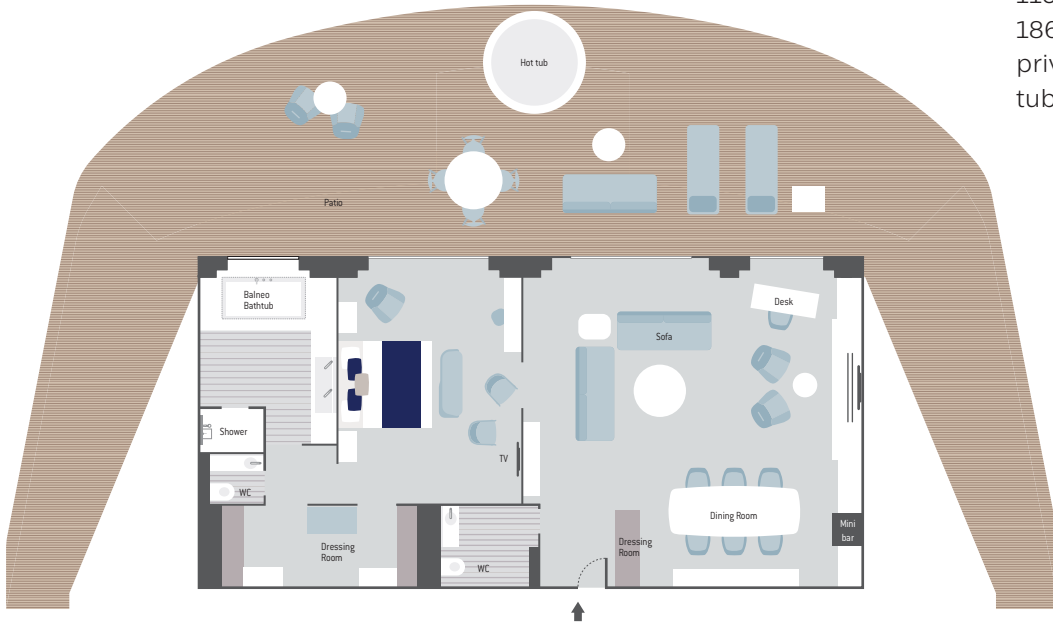

The Owner's Suite lounge, deck 8



The sleeping area of the Owner's Suite, deck 8



The Owner's Suite terrace, deck 8

360° TOUR - Explore each stateroom and suite by aiming your camera at the corresponding QR code and picturing yourself on board.



● Duplex Suites

94 sq.m/1,011 sq.ft +
26 sq.m/279 sq.ft private
terrace with hot tub -
balneo bathtub



360° TOUR

360° TOUR



● Privilege Suites

48 sq.m/516 sq.ft +
12.5 sq.m/134.5 sq.ft private
balcony - balneo bathtub



The sleeping area of the Duplex Suite, deck 6



The Duplex Suite lounge, deck 6



The lounge of the Privilege Suite, deck 8



The Grand Prestige lounge, deck 6



The sleeping area of the Prestige Suite, decks 7 and 8



The sleeping area of the Prestige Stateroom, decks 6, 7 and 8

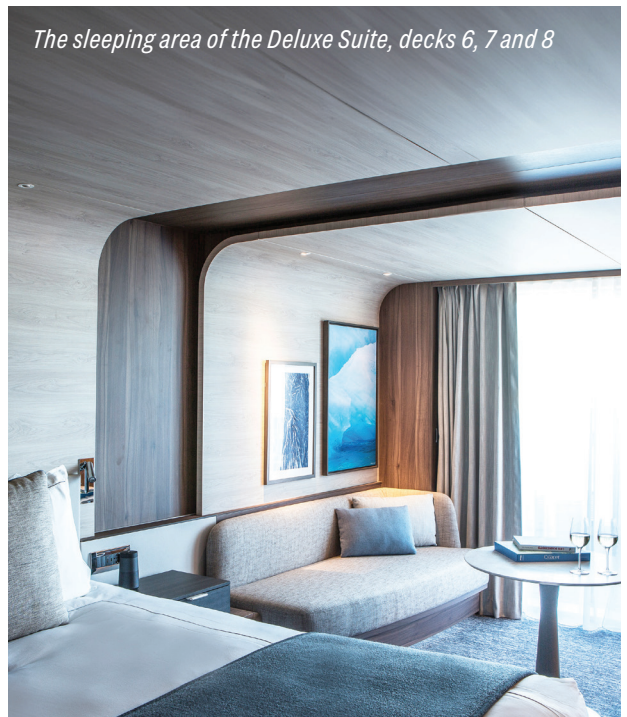

The sleeping area of the Deluxe Suite, decks 6, 7 and 8

Grand Prestige Suites ●

42 sq.m/452 sq.ft +
5 sq.m/54 sq.ft
private balcony

360° TOUR



➤ Prestige Suites

40 sq.m/430 sq.ft + 10 sq.m/107 sq.ft
private balcony

360° TOUR

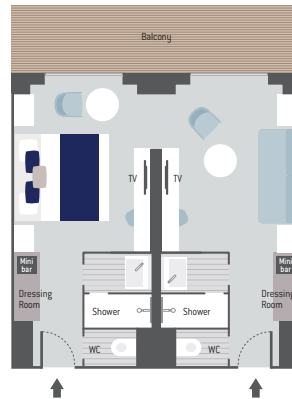

360° TOUR



Prestige Staterooms ●

20 sq.m/215 sq.ft
+ 5 sq.m/53 sq.ft private balcony



● Deluxe Suites

28 sq.m/301 sq.ft + 5 sq.m/53 sq.ft
private balcony

360° TOUR

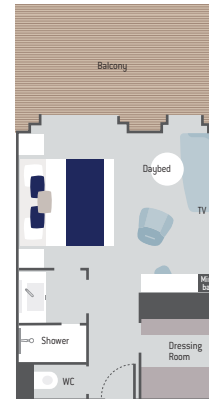

AMENITIES

- Private balcony for all staterooms and suites
- Terrace for Duplex Suites and the Owner's Suite
- Butler service and priority boarding: Owner's, Duplex, Privilege, and Grand Prestige Suites
- Individually controlled air conditioning
- Stateroom layout: king-size bed, or twin beds, adjoining staterooms available
- Mini bar
- 24-hour room service
- Satellite TV channels (availability dependent on navigation); selection of videos on demand

- Bose™ Bluetooth speaker
- Safe
- Selection of Diptyque Paris top-of-the-line bath products
- Dressing table, bathrobes, hairdryer
- Direct line telephone
- 110V American (two flat pins)/220V European (round sockets with two round pins)
- Internet access WiFi*

**Depending on the navigation area, WiFi may be inaccessible for reasons beyond our control.*

FORMALITIES

For all voyages

The information below is current but subject to change at any time without advance notice from government authorities. Please consult your respective government agencies for visa and health information.

Passport valid for at least six (6) months beyond the completion of your trip. Passport must contain at least two completely clear, blank, unused visa pages for each visa required, not including any amendment pages.

Visa pages with stains or ink from other pages in the passport are not usable. Guests who deviate from the scheduled embarkation or disembarkation port should research the foreign entry requirements for the port country. Due to government regulations, regrettably, PONANT will have to deny boarding to any guest who fails to obtain the appropriate travel documentation for this trip.

Specific formalities

ARCTIC

Reykjavík · Reykjavík May 4, 14, 24; June 7, 2025 ^{(4) (5)}

Reykjavík · Longyearbyen June 21, 2025 ^{(4) (5)}

Nuuk · Nuuk April 5, 2025 ^{(4) (5)}

Reykjavík · Nuuk March 21; April 17, 2025 ^{(4) (5)}

Longyearbyen · Longyearbyen July 22; August 6, 21, 2025 ^{(4) (5)}

Longyearbyen · Nome September 5, 2025 ^{(1) (4) (5)}

Saint Pierre and Miquelon · Québec January 17; February 10, 2025 ^{(3) (4) (5)}

Québec · Saint Pierre and Miquelon January 29; February 22, 2025 ^{(2) (3) (4) (5)}

Saint Pierre and Miquelon · Reykjavík March 6, 2025 ^{(2) (3) (4) (5)}

ANTARCTICA

Ushuaia · Ushuaia October 3; November 11, 23; December 5, 2025; January 2, 2026 ^{(4) (5)}

Ushuaia · Hobart January 16, 2026 ^{(4) (5)}

Hobart · Cape Town February 17, 2026 ^{(4) (5)}

(1) **USA:** depending on your nationality, an ESTA or Visa may be required. Please contact USA consulate website for details. A copy of your visa or ESTA must be sent to PONANT at the very latest 45 days prior to your cruise date. In case the ESTA is sufficient to enter the USA, we also ask you to keep a copy of your ESTA with your

passport throughout the duration of your trip.

(2) **Canada:** entry (or transit) by air. The eTA is required for Australian and British citizens, US citizens are exempt. Other nationalities, please contact Canada consulate website for details. <http://www.canada.ca/en/index.html>. A copy of your visa or eTA must be sent to PONANT at the very latest 45 days prior to your cruise date. In case the eTA is sufficient to enter Canada, we also ask you to keep a copy of your eTA with your passport throughout the duration of your trip.

(3) **Canada:** travel by sea. The eTA is not required for US, Australian and British citizens. Other nationalities: a visa may be required, please contact Canada consulate website for details: <http://www.canada.ca/en/index.html>

(4) Please note that for **polar plunge**, an EKG (electrocardiogram) by your general practitioner in addition to the PONANT medical questionnaire will be required. For persons under 18, we will require a sworn statement from the parents or legal guardians that they are able to swim. A parent or legal guardian must be present at the time of the activity.

(5) **Kayaking in polar region:** for persons under 18, we will require a sworn statement from the parents or legal guardians that they are able to swim. A parent or legal guardian must be present at the time of the activity.

Important information

To guarantee your entry into one or several countries, you must ensure that you comply with the formalities and health requirements specific to each destination. In just **a few clicks on our online search engine, find all the formalities you must complete prior to your departure** (visas, entry authorisations for each country, vaccinations, etc.): <https://en.ponant.com/formalities>.

The international situation can change rapidly, so be sure to check this information regularly prior to your departure. However, please note that we always recommend our guests contact the relevant national immigration and customs and border control authorities directly to find out what rules apply to their specific situation. PONANT is not responsible for any decisions made by guests based on the information provided by the online search engine.

Visas: before departure, please check carefully that your visas are valid for the right date and time spent in the countries in order to avoid unpleasant situations.

List of items prohibited on board: find here the full list of items prohibited on board: https://l.ponant.com/CGV_EN. Should you have one of these products or objects in your possession, they will be confiscated immediately and will not be transported on the ship. When an

item transported aboard is considered illegal, the relevant authorities will be notified systematically.

Boarding conditions and passenger travel abilities: we invite you to read our boarding conditions and passenger travel abilities at the following link: <https://l.ponant.com/ErQG>. Any new reservation implies the acceptance of these conditions.

Warning about the use of drones: the use of drones aboard PONANT ships, whether they are sailing at sea, at a port of call or anchored, is strictly forbidden. The use of drones on land in the Arctic and Antarctic regions is also strictly forbidden by international polar regulations. In other regions, it may be possible to use drones on land if permission has been obtained from the relevant authorities of each country and each region travelled through, as well as a pilot's licence that should be obtained from your home country. Guests are responsible for obtaining these permits; they should be able to present them at all times. Guests who do not obtain these authorisations expose themselves to the risk of legal proceeding.

Medication: if you have a medical condition, do not forget your prescription.



Polar expedition cruises

For all cruises marked with the logo 'parka gift', a PONANT polar water-resistant parka is offered (adult sizes only; in case of consecutive cruises, only one parka per person).

Boot rental will be offered onboard (for adults only) on expedition cruises where the logo 'free boot rental' appears.

Ports of call, activities, visited sites, outings and landings will depend on weather conditions, position of ice, winds and the state of the sea. These can force a change of plans at any time. The captain and the expedition leader may at any time cancel or stop any activity, or even modify the itinerary. The final itinerary will be confirmed by the captain, who will take into account the touristic quality of the sites and above all, the safety of the guests. His decision will be based on advice from experts and authorities.

Travelling to polar/isolated regions is an exhilarating experience in remote areas: please remember that you are far from modern hospitals with full medical facilities, thus evacuation is extremely expensive. Without adequate medical coverage, all expenses will have to be immediately paid with your personal funds. We urge you to subscribe to

full coverage insurance, choose your insurance company very carefully, be extremely vigilant and ensure your insurance is fully comprehensive, especially if you are insured by your credit card. PONANT offers an insurance contract with extensive guarantees, please contact us for more information.

Physical conditions for Nordic Skiing Polar Trek: participants need to be adult, to provide an EKG carried out less than 6 months prior to the departure and to be approved by shipboard doctor. Good physical condition is precondition. Participants should be in good physical shape: they have already practiced winter sports (skiing, snowshoeing, cross-country skiing) and are capable of walking 10 to 15 kilometres (around 6 to 9 miles) per day.

Discover the general and particular conditions of sale by scanning this pictogram.





420 Lexington Avenue, Suite 2838
New York, NY 10170



FOLLOW US ON SOCIAL MEDIA



facebook.com/LeCommandantCharcotEN



Instagram: @lecommandantcharcot



Twitter: @ponant_cruises



YouTube: PONANT Cruises



(1) Price is per person, based on double occupancy. The fares mentioned on each product reflect the best rates available at the time of publication, August 2024. Prices vary over time depending on the availability of our cruises and are thus subject to change without notice. (2) Double cabin supplement for single occupancy waived on a limited number of cabins and according to cabin category. Offer valid on select cruises. Find all the cruises concerned on our website. (3) Included flights selected by PONANT in economy class. Prices may change depending on availability and prices charged in real time by airline companies. The itineraries, activities, wildlife, highlights, as well as the photos used in this brochure are only possible experiences and therefore cannot be guaranteed. Find more information in the 'General Terms and Conditions of Sale' at www.ponant.com. All rights reserved. Non contractual document and photos. Photo credits: ©Studio PONANT: Sylvain Adenot, Olivier Blaud, Ophélie Bleunven, Romain Farge, Laurence Fischer, Joanna Marchi, Morgane Monneret. ©PONANT: Camille Bignan, Ian Dawson, Daniel Ernst, Julien Fabro, Sue Flood, Mike Louagie, Cindy Miller Hopkins, JC Pieri, Téo Quillier, Gilles Trillard, Violette Vauchelle. ©Istock: Keith Szafranski, Duncan1890, Evgeniy Biletskiy, Nick Tsuguliev, Sara Ortin Leon, Ruslan Kaln, Vlad Orlov, Medaacek, Subodh Agnihotri, Elin Moe, Standret, Artur Dancs, Kevin Pluk, Paolo Graziosi, Sami Auvinen, Lainea, Edsel Querini, Kjekol. ©AdobeStock: Neocortex, ACD Systems Digital Imaging, Tommy Dahl Markussen, Israel Sautier, Daniel Freese, Viktor Descenko. ©Rvé Milliard Photographe. ©M.Turbide. ©Stirling Design International. ©Eydis Gudmundsdottir. ©RonClifford. ©LeMeurice. Illustrations: ©Infostrates, ©Anne Ouvrard, ©The Editorialist, ©Studio PONANT, ©Full Content. Editors: Epoque - The Editorialist - Full Content - Damien Guillou - Caroline Lumet. Brochure design and graphic production: Studio PONANT - C&O Le Cabinet de Communication, August 2024.

RELEASE DATE: AUGUST 2024